

# SLUM2SCHOOL GREEN ACADEMY

## PROJECT REPORT

OCTOBER 2025

### PARTNERS:



Norwegian Embassy







**Folagbade, 7 years old, Nursery 2, on his first day at the Slum2School Green Academy.**



# Table of Contents

▶▶▶	Cover Page	
▶▶▶	Table of Content	03
▶▶▶	Message from the Executive Director	06
▶▶▶	Executive Summary	07
▶▶▶	Slum2School x BioMérieux	08
▶▶▶	Slum2School x HP	09
▶▶▶	Slum2School x United Airlines	10
▶▶▶	Slum2School x Nowergian Embassy	11
▶▶▶	Slum2School x Lagoos State Government	12
▶▶▶	Project Implementation Team	13

## ▶▶▶ CONTEXT & BACKGROUND

Who we are: Slum2School Africa	14
Our growing impact	15
Saga and Neighboring Communities	16
Project Goal, Objectives, and Theory of Change	18
Project Rationale and Needs Assessment	19
Proposed project 3D Design	21

## ▶▶▶ IMPLEMENTATION & DESIGN

Project Success Stages	25
Project Milestones	26
Construction Process and Logistics	27
Project Construction Phases	28
<ul style="list-style-type: none"> <li>Community engagement, participation, and workshops</li> </ul>	31
<ul style="list-style-type: none"> <li>Groundbreaking ceremony</li> </ul>	34
<ul style="list-style-type: none"> <li>Sand Filling</li> </ul>	41
The Green Academy Model	61
Education Curriculum and Seven (7) Pillars	62

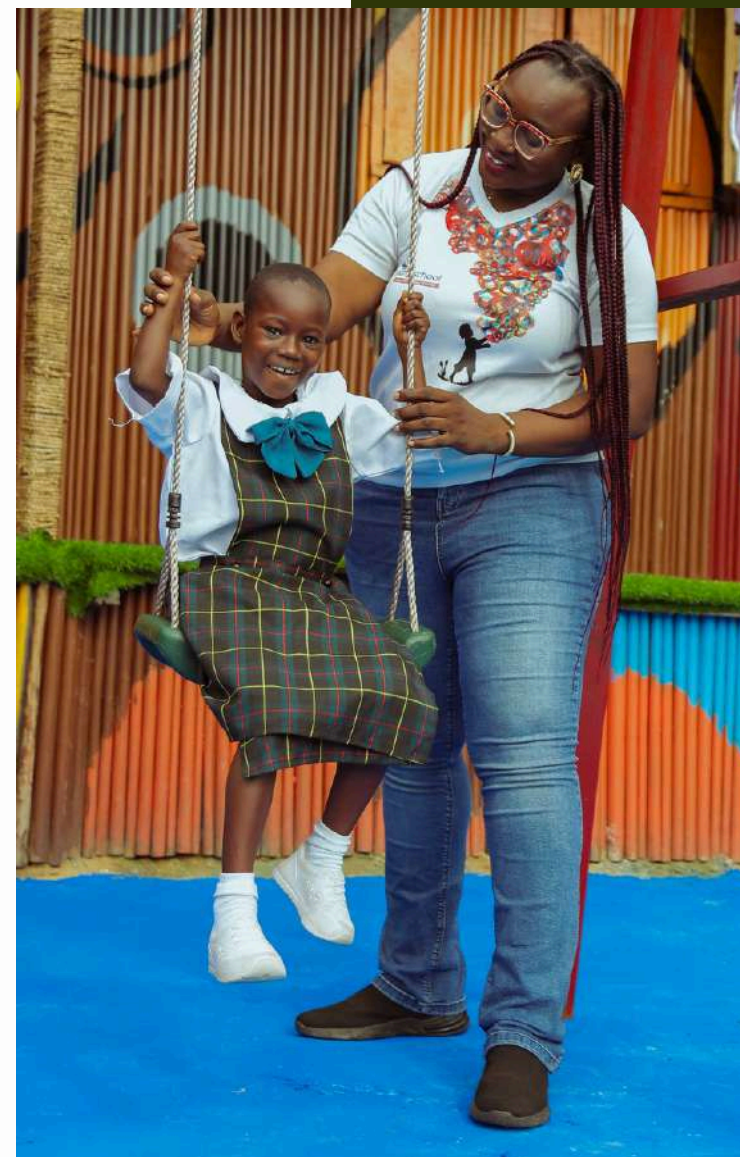

# Table of Contents

Digital and Technological Integration	63
---------------------------------------	----

Slum2School Green Academy – Innovative Affordable School	64
----------------------------------------------------------	----

## IMPACT & OUTCOMES

Enrollment and Access to Education	69
------------------------------------	----

Teacher Development and Capacity Building	71
-------------------------------------------	----

Psychosocial and Health Support Systems	72
-----------------------------------------	----

Community Empowerment and Economic Impact	73
-------------------------------------------	----

Volunteerism and Global Engagement	75
------------------------------------	----

Partnership Showcase – Other Allied Sponsors	76
----------------------------------------------	----

Stories of Change and Testimonials	77
------------------------------------	----

## VISIBILITY, DATA & LEARNING

In the News	80
-------------	----

Impact Data and Key Results Dashboard	82
---------------------------------------	----

Monitoring, Evaluation, Accountability and Learning (MEAL)	83
------------------------------------------------------------	----

Research and Replication Potential	85
------------------------------------	----

Safeguarding and Child Protection	86
-----------------------------------	----

## CHALLENGES, FINANCES & FUTURE

Challenges and Mitigation Strategies	88
--------------------------------------	----

Sustainability Plan and Next Steps	90
------------------------------------	----

Financials	91
------------	----

Outstanding Projects	94
----------------------	----

The Green Academy & the Future	95
--------------------------------	----

Appreciation Message	96
----------------------	----

## CONTACT

Contact page	98
--------------	----





**“TO EDUCATE A CHILD IS TO SHAPE  
A NATION.” - AFRICAN PROVERB**





# MESSAGE FROM THE EXECUTIVE DIRECTOR

When we first arrived in Saga, what we saw was not just an underserved community – we saw potential waiting to bloom. Beneath the narrow bridges and wooden shacks were children with eager eyes and restless dreams. They were out-of-school, not because they lacked curiosity, but because opportunity had not reached them. We began supporting their learning in makeshift classrooms built from wood and thatch, humble spaces, yet alive with laughter and hope. Those early moments reminded us that education begins with belief – the belief that every child, regardless of background, deserves a chance to learn and thrive.

From that belief, the vision for the Slum2School Green Academy emerged – a bold idea to create a sustainable, inclusive, and innovative learning environment that could transform not only the lives of children in Saga but also serve as a replicable model across Africa. Today, through our catalytic partnership with BioMérieux through the bioMérieux Endowment Fund and the collaboration of other incredible purpose-forged partners, architects, engineers, teachers, and volunteers, that vision has become reality. The Slum2School Green Academy now stands as a living ecosystem of innovation. Constructed with bamboo architecture, fully powered by solar power, and equipped with rainwater harvesting water borehole, biogas digesters for waste to gas conversion, digital learning lab, arts and music spaces, sports facilities, and biodiversity zones, the Academy represents what's possible when human potential meets purpose. Every design choice was intentional – to nurture not just learning, but wellbeing, creativity, and environmental consciousness.

Today, about 250 children who were once out of school now learn here daily, discovering science, learning about the world, and developing self-confidence. They are guided by passionate educators and supported by psychosocial and health programs that ensure holistic development. Around them, the entire community has been reawakened. Parents now volunteer, local trades flourish, and pride fills the air. Where once stood isolation, now stands inspiration.

To BioMérieux, your commitment to this project has been extraordinary. You believed in this dream when it existed only as sketches and ideas, and we say thank you as you have demonstrated how corporate philanthropy can transcend charity – becoming legacy. We also extend heartfelt appreciation to our many partners – like HP, United Airlines, the Norwegian Embassy, Mavin and several others – donors, volunteers, and government collaborators whose contributions gave this project life. As we look to the future, we know this is only the beginning. The Slum2School Green Academy stands as a replicable model of what Africa's education systems can become – sustainable, inclusive, and future-focused. Our goal is to scale this vision, bringing learning, dignity, and hope to every child still waiting for a chance.

The Slum2School Green Academy is not the end of a project but the beginning of a movement – one that reimagines education, restores dignity, and reshapes what's possible for Africa's next generation. Together, we have built not just a school, but a symbol of what the future can be and we invite you to join us as we sustain this legacy for future generations.

With gratitude,



**Orondam Otto**

Founder/Executive Director  
Slum2School Africa





# EXECUTIVE SUMMARY

The Slum2School Green Academy was conceived to transform access to education in Saga, a riverine community in Lagos that had existed for over a century without a single school. For generations, children in Saga grew up without classrooms, electricity, or safe drinking water, their dreams constrained by isolation and deep inequities. The Green Academy was envisioned as a bold response to this reality: to create an inclusive, sustainable, and future-ready learning environment that would not only educate children but also uplift the entire community.

From inception, the project prioritized community ownership. Through continuous advocacy, town hall meetings, and engagements with the Local Government Chairperson, community leaders, and parents, the vision of the Green Academy was shaped by the people it was built to serve. Community members played an active role throughout construction, volunteering labor, offering local insights, and standing proudly as partners in progress.

Built with durable bamboo architecture to withstand the lagoon's climate, the Academy represents a fusion of innovation and sustainability. It is fully powered by solar energy, bringing electricity to Saga for the first time, while clean water is provided through boreholes and rainwater harvesting systems. Biogas digesters convert waste into energy, promoting hygiene and environmental responsibility. With satellite internet, the Academy connects children in Saga to the global classroom, opening doors to knowledge and opportunity beyond their shores.

Commissioned in September 2025, the Green Academy today provides access to quality education for over 250 children from Saga and seven neighboring communities. It also serves as a hub for holistic community development, offering healthcare, psychosocial support, digital learning, play spaces, and accommodation for teachers. Community members now benefit indirectly from improved access to clean water, energy, and essential services. The Academy stands as a living model of how education can drive both social and environmental transformation, turning one community's story of exclusion into a testament of hope and resilience.

This milestone was made possible through the vision and generosity of the bioMérieux Endowment Fund, whose partnership transformed a shared dream into reality. Their commitment to innovation, sustainability, and human development has not only changed lives in Saga but has also set a powerful example for what collaboration can achieve.

Together, we have built more than a school, we have built possibility. The Slum2School Green Academy now stands as a beacon of what is achievable when compassion, creativity, and community come together to reimagine the future of education in Africa.





# SLUM2SCHOOL X BIOMÉRIEUX

The collaboration between Slum2School Africa and the bioMérieux Endowment Fund was forged through a shared vision to expand access to quality education for children in underserved communities. As Slum2School sought strategic partners to scale its impact and establish a sustainable learning model in Saga, the bioMérieux Endowment Fund - with its deep commitment to advancing health, education, and human development - stepped forward as a catalytical partner.

Together, both organizations combined innovation, expertise, and compassion to create the Slum2School Green Academy, a transformative model of sustainable education that now stands as a testament to what purposeful partnership can achieve.

With ~40% of the project's funding provided by the bioMérieux Endowment Fund, the partnership embodied our shared commitment to the UN Sustainable Development Goals - particularly SDG 4 (Quality Education), SDG 3 (Good Health and Well-being), and SDG 13 (Climate Action).

Together, we fused innovation with sustainability: the Academy was built using bamboo architecture, powered entirely by solar energy, and equipped with clean water and digital connectivity - all designed to nurture learning in an environment that is safe, green, and inspiring.

This partnership reflects the Fund's mission to reduce inequalities through education and Slum2School's vision to ensure that every child can learn, dream, and thrive. It stands as a powerful example of what can be achieved when compassion, innovation, and shared purpose meet to transform lives and reimagine the future of education in Africa.



# SLUM2SCHOOL X HP

The partnership between Slum2School Africa and HP emerged from a shared vision to bridge the digital divide and empower children in underserved communities through technology. As part of the Green Academy project in Saga, HP's support became a catalyst for digital transformation, ensuring that children who once had no access to classrooms could now explore a world of learning through innovation.

With HP's contribution, the Academy's digital classroom was fully equipped with HP devices, creating a hub for interactive, technology-driven education. This initiative not only enhances literacy and numeracy but also introduces learners to STEM, coding, and global digital resources, preparing them for a rapidly evolving world.

The partnership reflects HP's global commitment to advancing digital equity and sustainable impact, aligning strongly with the UN Sustainable Development Goals, particularly SDG 4 (Quality Education) and SDG 9 (Industry, Innovation, and Infrastructure).

Together, HP and Slum2School Africa have demonstrated that technology, when guided by purpose, can unlock opportunity, amplify potential, and inspire a generation of learners to dream beyond boundaries.

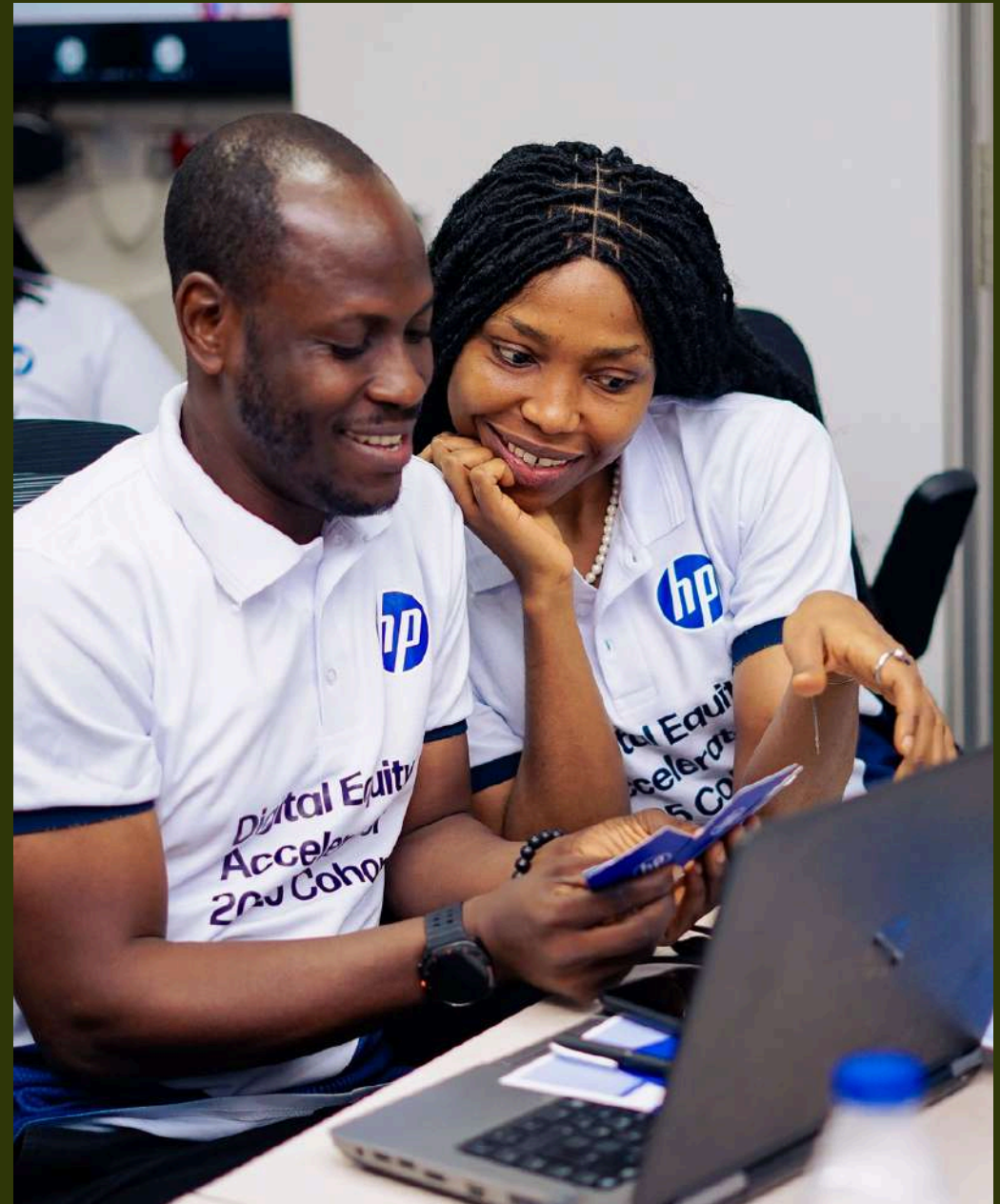

# SLUM2SCHOOL X UNITED AIRLINES



United Airlines and Slum2School Africa partnership was rooted in a shared belief that access to education can open a world of possibilities for every child, no matter where they are born. During the early stages of the Green Academy's construction, United Airlines stood beside us, providing essential learning materials; books, backpacks, and school supplies, to children who were already enrolled and learning in temporary spaces.

Their contribution symbolized more than the gift of materials; it was a message of encouragement, reminding every child that their dreams are valid and their future limitless. Months later, as the Green Academy was completed, United Airlines continued to celebrate the progress and transformation their early support helped make possible.

This partnership reflects United Airlines' ongoing commitment to community upliftment and educational access, echoing their global mission to connect not only people to places but also hope to opportunity.

We proved that when compassion takes flight, it can carry the dreams of children far beyond the horizon.



# SLUM2SCHOOL X NOWERGIAN EMBASSY



The Norwegian Embassy's partnership brought a powerful boost to the Green Academy's vision for early childhood learning. Through their support, the school now features vibrant early learning and maker spaces where young children can explore, play, and learn through creativity and hands-on experiences. This contribution perfectly complements Slum2School's commitment to holistic education; ensuring that children in Saga begin their learning journey in spaces that inspire imagination and build confidence.

The Embassy's support reflects a shared belief that strong foundations in early education lead to stronger communities. Their investment in innovation and inclusion continues to make a lasting impact on how learning begins for hundreds of children across the lagoon communities.



# SLUM2SCHOOL X LAGOS STATE GOVERNMENT



A project of this magnitude cannot thrive without the collective strength of community and the unwavering support of government. From the first visit to Saga, we witnessed a rare kind of unity, one driven by hope and a shared dream for the children.

Our community leaders played a remarkable role in championing this vision. They opened their doors, rallied their people, and ensured that the community felt a deep sense of ownership in this project. They became advocates, guardians, and even volunteers, ensuring that every phase of the Green Academy's construction reflected the spirit and aspirations of the people.

The LGA Chairperson was equally instrumental, offering guidance, encouragement, and on-the-ground support that kept the work moving forward, even when challenges arose. Their belief in the value of education as a tool for transformation strengthened our resolve to keep going and to keep building.

We're also deeply grateful to the Lagos State Universal Basic Education Board (LASUBEB) for their continued collaboration and oversight. Their partnership ensured that the academy aligned with the state's education standards while also setting a new benchmark for what inclusive, sustainable learning spaces could look like in underserved communities.

Together, this collaboration between Slum2School, the government, and the community showed what's truly possible when hearts align for a greater purpose. It's a reminder that lasting change doesn't happen in isolation, it grows from trust, shared vision, and collective action.



# PROJECT IMPLEMENTATION TEAM



**Oluyemi Alugo**  
Education and Innovation



**Adekunle Idowu**  
Project Management



**Lois Ifeanyichuwu**  
Growth and Fundraising



**Hammed Balogun**  
Finance Management



**Patience Osinaike**  
Programme Management



**Ushang Achu**  
Architecture and Construction



**Hauwa Yahaya**  
Partnership Management



**Henry Akodoye**  
Project management



**Catherine Echem**  
Talent & HR Management



**Ania Judson**  
Curriculum Design



**Ekene Chukwuma**  
Project Management



**Dolapo Johnson**  
Curriculum Design



**Mojetoluwa Adedeji**  
Partnership Management

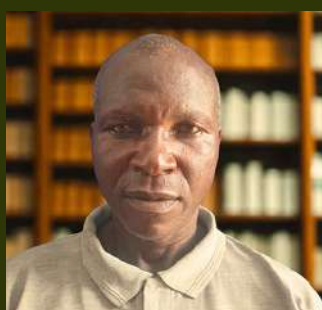

**Emiloju Omosuwa**  
Operation and Logistics



**Victoria O. Ajise**  
Curriculum Design



**Michael Reuben**  
Project Coordinator



**Angele Collins**  
Curriculum Design



**Toluwanimi Fatukasi**  
Curriculum Design

# WHO WE ARE

## Slum2School Africa

Slum2School Africa exists to transform the lives of underserved children across Africa by providing access to quality education, safe learning spaces, and holistic development opportunities.

We are bridging inequality by designing innovative, inclusive, and sustainable education models that empower children, strengthen communities, and unlock Africa's human potential. Our approach integrates academic learning with technology, life skills, health, and psychosocial support - ensuring that every child not only learns but thrives.

Through strategic partnerships, volunteer engagement, and advocacy, we are building collaborative systems and ecosystems of change to end the education crisis in Africa.

Together, we are shaping a future where every child, regardless of circumstance, can dream boldly, learn confidently, and lead transformational change within their communities and beyond.





# OUR GROWING IMPACT

We have spent everyday of the past 13 years working to end the education crisis in Africa, and we have done this with an ever growing team of changemakers committed to changing the world together



**710,450**

**children, including adolescents reached**

with access to education, skills and talent development, health and psycho-social support, and development programs



**283**

**schools supported**

through interventions and outreaches



**45,410**

**volunteers globally** have supported our course to promote quality education for children in slum and remote communities.



**75% & 79%**

**academic performance**

of children achieving at least an average in literacy and numeracy respectively



**554**

**communities reached** with interventions and awareness on education and community development



**3.5m**

**combined volunteer**

**hours** across 65 countries



**5,932**

**teachers supported**

through professional teachers development training



**200+**

**corporate & institutional partners**

including HP, Google, UNICEF, United Airlines, and more — building sustainable impact together.

An aerial photograph showing a coastal village with numerous small, simple houses with corrugated metal roofs. The village is situated along a winding river or lagoon. To the left of the village is a large, circular, fenced-in area, possibly a sports field or a community gathering space. The surrounding landscape is lush green, with dense vegetation and a large body of water in the background.

# **SAGA AND NEIGHBORING COMMUNITIES**

**Saga and its neighboring lagoon communities are home to about 7,000 residents - mostly fishermen, boat builders, traders, and artisans whose lives depend on the water. Despite economic hardship, they are held together by strong values of unity, resilience, and mutual support that have sustained them through decades of marginalization and neglect.**

**Before the Slum2School Green Academy's intervention, education was virtually absent. There was no school in Saga or nearby settlements, and most children grew up without ever entering a classroom. Those seeking education had to travel long distances by canoe to neighboring towns, an option too costly and unsafe for most families. As a result, literacy rates were extremely low, and early childhood learning remained largely unsupported.**



**The community also lacked electricity, clean water, and healthcare, leading to preventable fatalities, creating a cycle of poverty that stifled progress and opportunity. Yet, through the needs assessment and town hall meetings held by Slum2School, one aspiration echoed across every household - to give their children the chance to learn and thrive.**

**The Slum2School Green Academy emerged in response to this collective dream, offering not only access to quality education but also hope, dignity, and a sustainable path to transformation for Saga and its neighboring communities.**





# PROJECT GOAL, OBJECTIVES AND THEORY OF CHANGE

The Slum2School Green Academy Project was designed to break the cycle of educational exclusion and environmental neglect in Saga and its neighboring communities, creating a replicable model for sustainable, community-driven development.

## GOAL

To ensure equitable access to quality early childhood education and improve the overall well-being of children and families in the Saga community through sustainable infrastructure, capacity building, and inclusive community participation.

## PROJECT OBJECTIVES

1. Establish a community-centric early childhood school for children aged 1–10 years, providing foundational learning opportunities where none previously existed.
2. Empower children and families through scholarships, quality learning materials, and psychosocial support.
3. Build local capacity by training and equipping teachers to deliver child-centered, inclusive education.
4. Promote environmental sustainability by constructing the academy using bamboo and renewable materials and integrating solar power, biogas, and rainwater systems.
5. Strengthen community resilience by providing clean water access, teacher housing, and safe transportation (boats and life jackets) for learners.

## THEORY OF CHANGE - STATEMENT

If communities invest in building a sustainable, community-driven Green Academy that provides quality early childhood education, clean water, renewable energy, and trained teachers within an inclusive environment, then children will gain equitable access to learning and essential services, leading to improved education, health, and livelihoods - and ultimately transforming the community into a model of resilience, sustainability, and hope.



# PROJECT RATIONALE AND NEEDS ASSESSMENT

The Slum2School Green Academy was established to address the pressing educational, social, and environmental challenges in Saga and its neighboring riverine communities. For over a century, these settlements had no formal school, leaving generations of children excluded from learning opportunities and limiting their potential for growth. Through a participatory needs assessment, Slum2School Africa identified key priorities that shaped the project's holistic design.

## Key Project Rationales and Needs Assessment Findings:

- No access to formal education, leaving hundreds of children out of school.
- Unsafe and distant travel by canoe to other communities led to frequent dropouts.
- Poor living conditions, with no electricity, clean water, or sanitation facilities.
- Socioeconomic isolation deepened vulnerability for women, girls and children.
- Community priorities identified education, renewable energy, water, and hygiene as urgent needs.
- Lack of early childhood development support, leaving young children without access to foundational learning.
- Limited access to healthcare and psychosocial support, contributing to poor health outcomes and unaddressed trauma among children and families.

The Green Academy now stands as a sustainable model of inclusive education and community transformation.



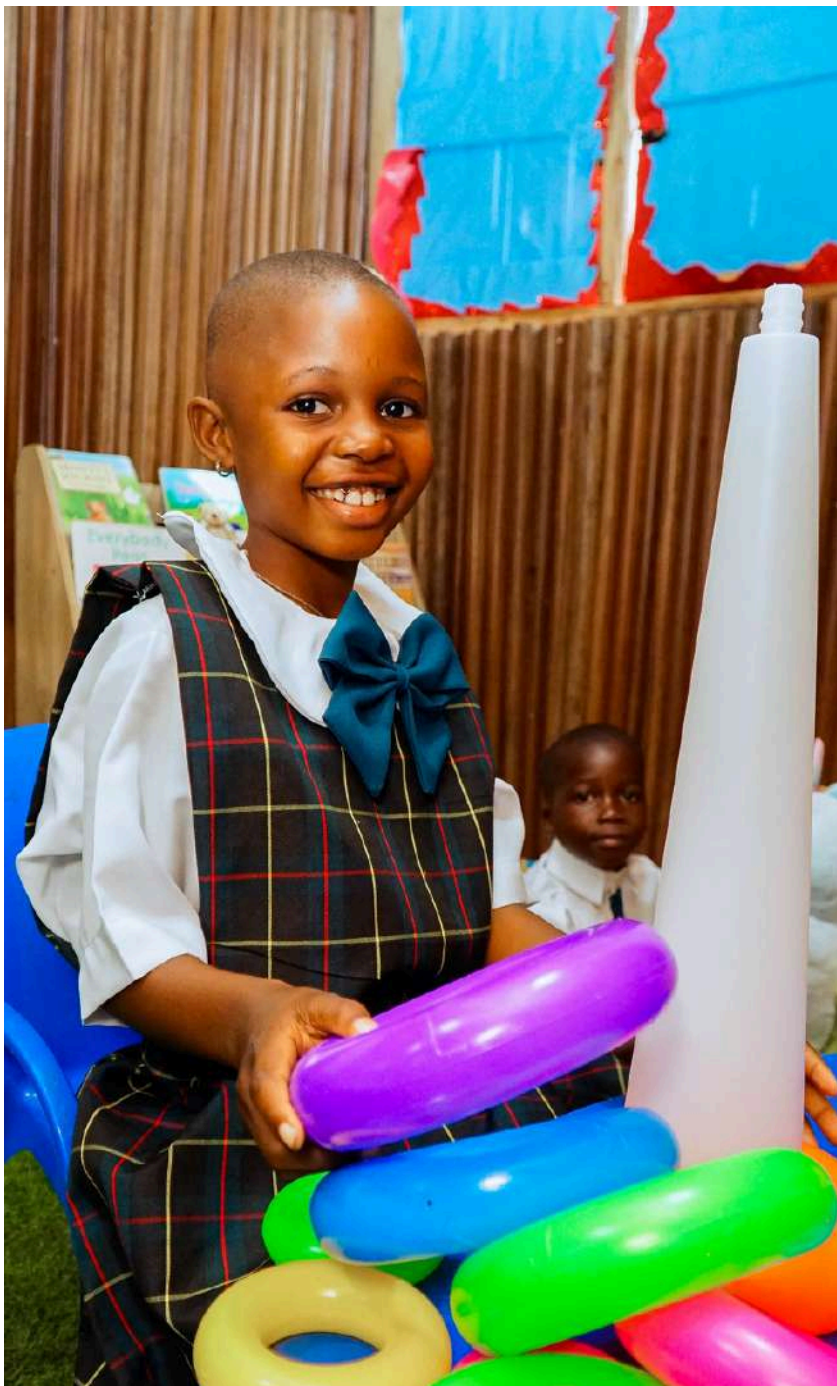

## THEORY OF CHANGE - SLUM2SCHOOL GREEN ACADEMY

<b>IMPACT</b>	Reduced inequality through access to education Empowered generation of skilled, confident leaders. Sustainable community transformation and lifelong opportunity
<b>OUTCOMES</b>	Increased enrollment & attendance Improved literacy & early learning Stronger community ownership Enhanced environmental awareness
<b>OUTPUTS</b>	1 Green Academy built in Saga community with 15+ classrooms. 250 children enrolled with 10 teachers recruited and fully trained. 27kW solar system. 4 studio apartment staff quaters.
<b>ACTIVITIES</b>	Build classrooms, train teachers, and engage communities. Deliver digital, STEM, and creative learning programs. Provide nutrition, psychosocial, and health support
<b>INPUTS</b>	Funding, volunteers, materials, curriculum, solar energy. Technical expertise, partners, and community resources. Digital tools, bamboo, and sustainable building materials



# PROPOSED PROJECT 3D DESIGN



To guide our construction team, a detailed 3D model was designed by our architecture team, illustrating the Green Academy's circular layout featuring staff quarters, classrooms, digital lab, walkways, play area, and water systems, highlighting its sustainable bamboo architecture, community-centered design, and Africa-inspired motif promoting inclusive learning and environmental harmony.





From left to right - 3D design views showcasing the inner play areas within the school's circular courtyard, the digital lab & library, early childhood classroom, and an aerial perspective highlighting the solar panels and vibrant outdoor play space.

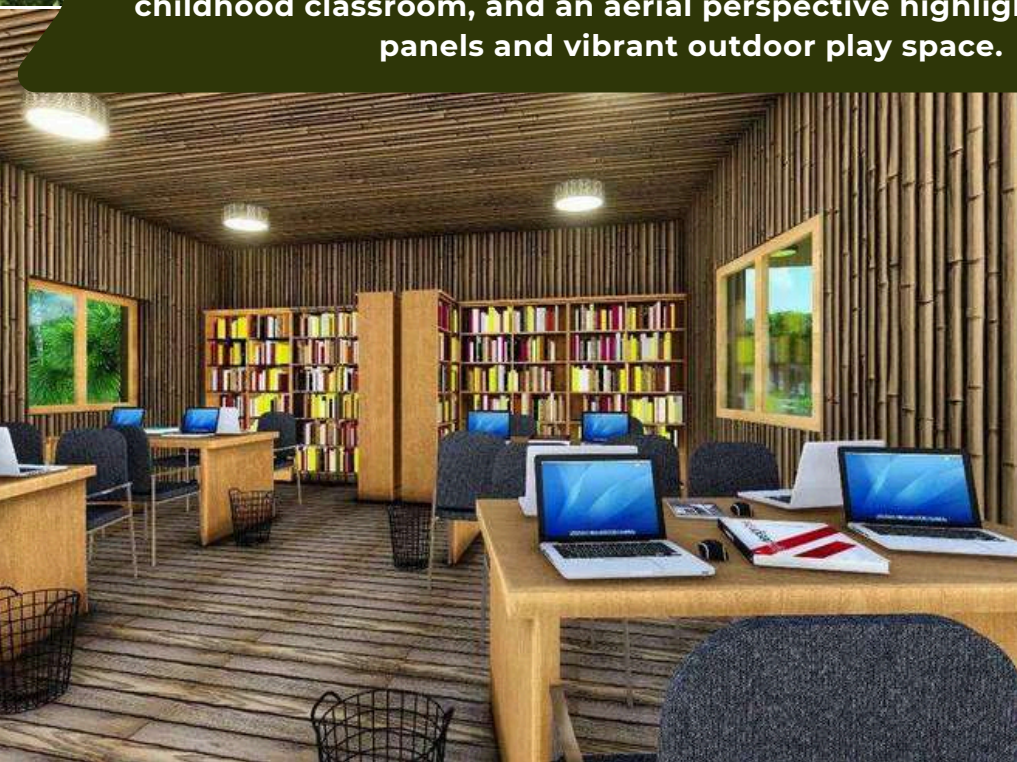





**SAGA COMMUNITY MEMBERS EXCITED TO WELCOME  
SLUM2SCHOOL, PARTNERS, VOLUNTEERS AND OTHER  
STAKEHOLDERS DURING THE A COMMUNITY VISIT**





**IMPLEMENTATION AND DESIGN**



# PROJECT SUCCESS STAGES

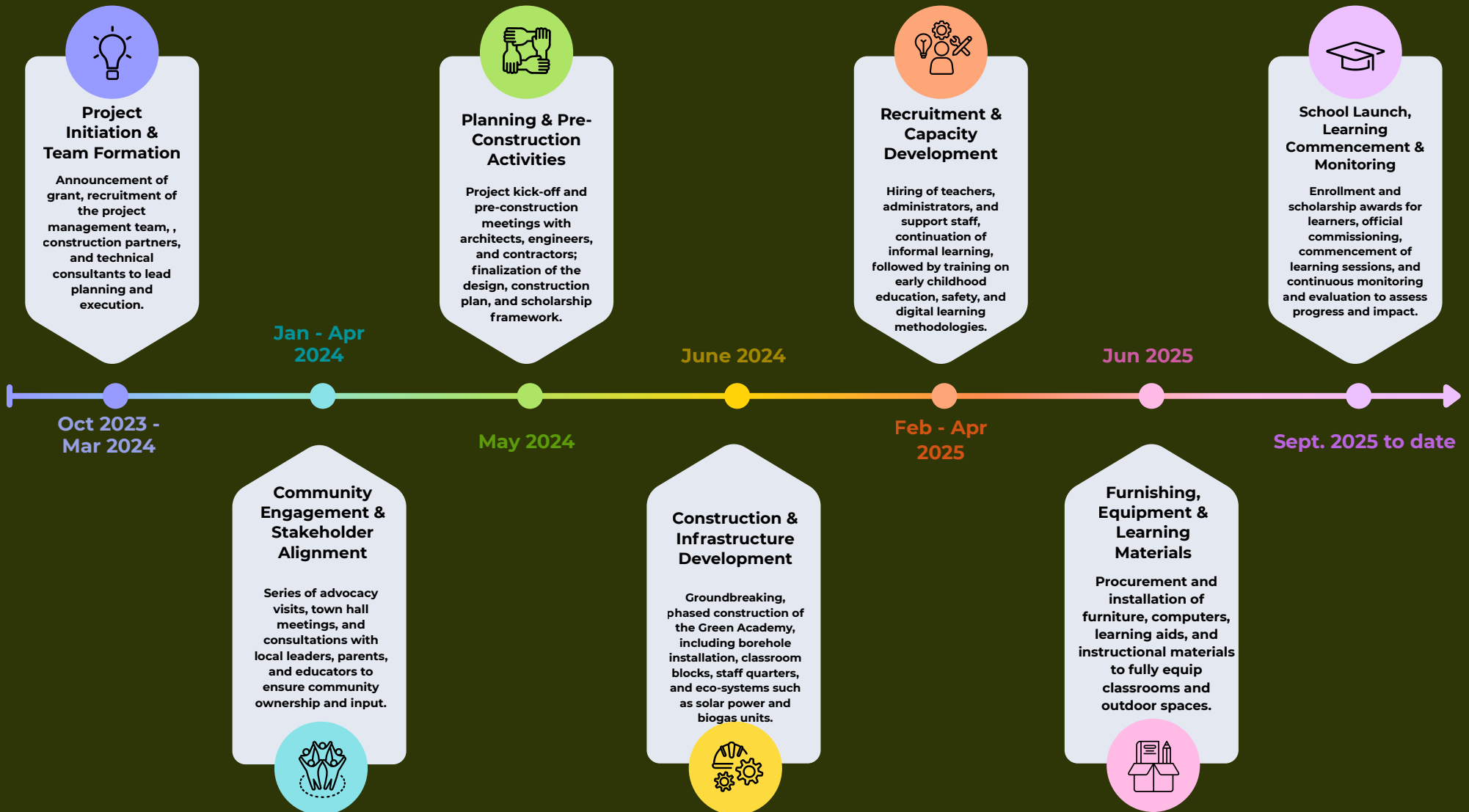

# PROJECT MILESTONES



**EXCITED CHILDREN IN THE COMMUNITY  
LEAPING TO CATCH A DRONE**





# CONSTRUCTION PROCESS AND LOGISTICS

The construction of the Green Academy was a collaborative and adaptive process that blended innovation with community participation. All materials were locally sourced, prioritizing bamboo and other eco-friendly resources suited to the coastal environment. This approach empowered local artisans and craftsmen, creating jobs and transferring green building skills within the community.



From the foundation stage to the final touches, community members actively participated, supporting site preparation, logistics, and material transport by canoe across the river. Volunteers and local labor worked alongside technical experts to ensure quality, safety, and cultural relevance in the school's design.



Despite challenges such as difficult terrain, unpredictable weather, and the complexities of transporting materials over water, the project team demonstrated resilience and creativity. Construction timelines were adjusted through flexible scheduling, and local innovations were applied to overcome logistical barriers.



Through collective effort and shared vision, the Green Academy rose from bamboo and sandbanks into a symbol of what partnership and persistence can achieve, transforming both the landscape and the spirit of the Saga community.





# PROJECT CONSTRUCTION PHASES





**SCHOOL SITE BEFORE CONSTRUCTION BEGAN**





**AERIAL VIEW OF THE SLUM2SCHOOL  
GREEN ACADEMY IN SAGA COMMUNITY**







## COMMUNITY ENGAGEMENT, PARTICIPATION & WORKSHOPS

From the very inception of the Slum2School Green Academy project, community involvement was at the heart of every stage.

Slum2School held a series of advocacy visits, town hall meetings, and stakeholder engagements with the Local Government Chairperson, traditional leaders, youth, and parents to ensure full community ownership.

These dialogues helped shape the project's design, location, and priorities, aligning the Academy with the real needs and aspirations of the people of Saga.





**STAKEHOLDER ENGAGEMENT WITH EPE LOCAL GOVERNMENT LEADERS, AND CHAIRPERSON, PRINCESS SURAH OLAYEMI ANIMASHAUN**





**STAKEHOLDERS INCLUDING BIOMÉRIEUX & SLUM2SCHOOL TEAM LEADERS DURING A HEALTH OUTREACH AT SAGA COMMUNITY**



# GROUNDBREAKING CEREMONY

The school construction groundbreaking event was held on the 7th of June 2024 which brought together several stakeholders including the Epe local government team/representatives, Ministry of Education - SUBEB representative team, Community heads, and leaders, key dignitaries, DSS, Partners - bioMérieux team, Volunteers and many more.

The highlights of the event included cultural performances from children and the community youth, project presentation, dignitary keynote speeches, and health/hygiene education - oral education for learners and community people, including donation of items from the bioMérieux staff.



**VOLUNTEERS AND STAKEHOLDERS AT THE PROPOSED SCHOOL SITE**





**VARIOUS STAKEHOLDERS AND PARTNERS AT THE  
GROUND BREAKING CEREMONY.**





**THE FOUNDATION BEING CONSTRUCTED TO GET THE ACCURATE CIRCULAR SHAPE AND A STRONG BASE USING IRON WOOD.**





**SLUM2SCHOOL PROJECT TEAM LEADERS  
VISITING THE PROJECT SITE AT THE EARLY  
STAGES TO MONITOR PROGRESS**





**AERIAL VIEW OF THE STRUCTURAL  
WOODWORK AT THE EARLY STAGES OF  
THE SCHOOL CONSTRUCTION.**







**AT WEEK 16, THE RIGHT WING WAS COMPLETED, HOWEVER THE PLAY AREA REMAINED WATERLOGGED, WHICH WILL LATER BE SAND-FILLED, FLOORED, AND TURFED TO ENSURE A SAFE RECREATIONAL SPACE FOR LEARNERS.**



**AERIAL VIEW OF THE SCHOOL  
CONSTRUCTION SITE AT WEEK 16 SHOWING  
THE HIGH TIDAL LEVEL AND WATERLOGGED  
SURROUNDINGS**

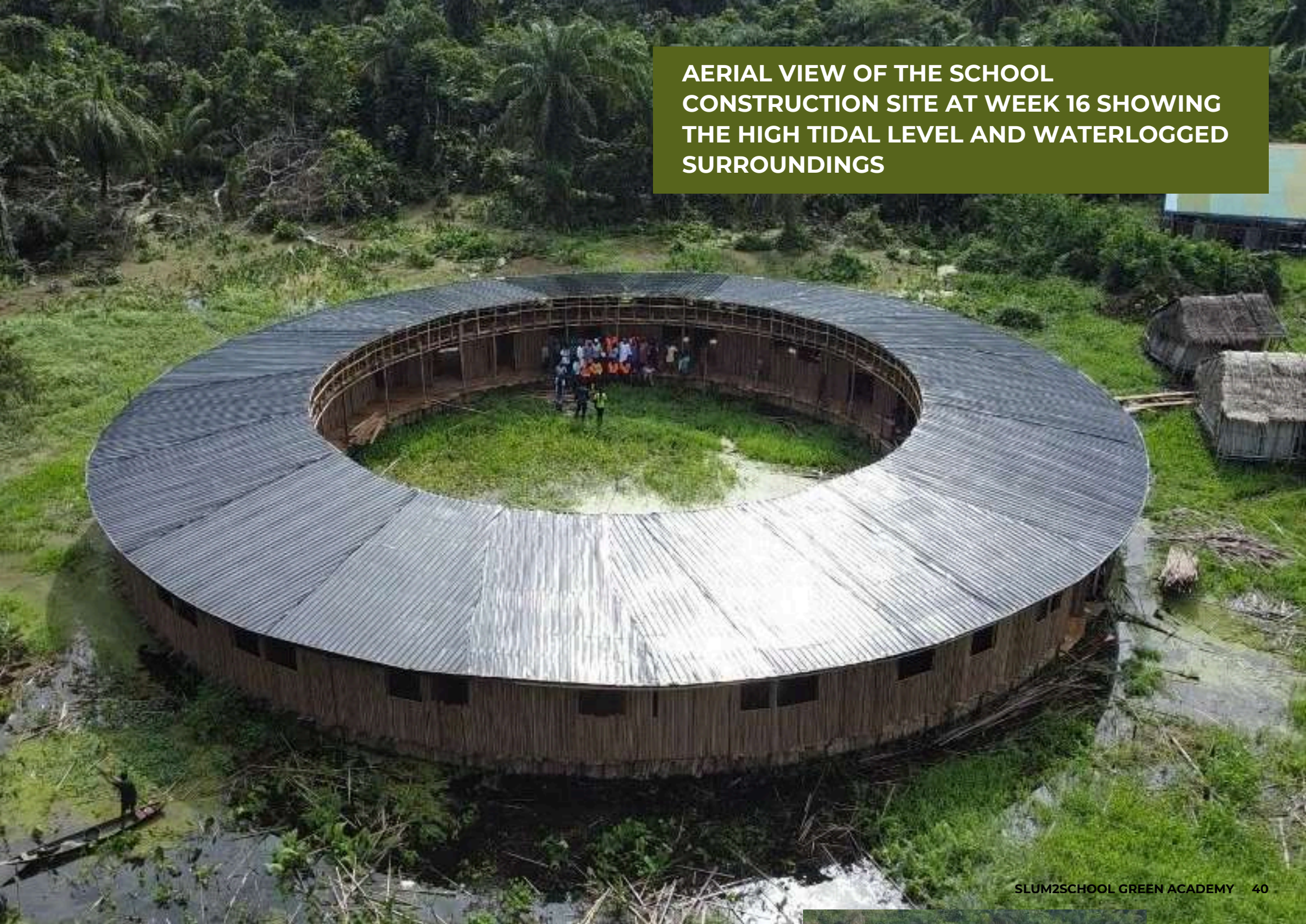



# SAND FILLING

SCHOOL SITE MANUALLY  
SANDFILLED

SAND ESCAVATION  
TEAM RETURNING FROM  
THE RIVER WITH A  
HEAPED BOAT OF SAND



ESCAVATED SAND FROM THE  
RIVER IS OFFLOADED BY THE  
SHORE.



SAND IS WHEELBARROWED TO  
THE SCHOOL SITE BY  
VOLUNTEERS



250 BOATS TRANSPORTED 30 TON OF SAND EACH,  
MANUALLY EXCAVATED FROM THE RIVER AROUND THE  
COMMUNITY TO FILL UP THE SCHOOL PERIMETER







**PANORAMIC VIEW OF  
THE INTERNAL  
WATERLOGGED  
PREMISES OF THE  
SCHOOL DURING  
CONSTRUCTION**

**PANORAMIC VIEW  
OF THE INTERNAL  
SANDFILLED  
PREMISES OF THE  
SCHOOL DURING  
CONSTRUCTION**



**PANORAMIC VIEW  
OF THE COMPLETED  
PLAY AREA OF THE  
SCHOOL AFTER  
CONSTRUCTION**





**AERIAL VIEW OF SCHOOL  
CONSTRUCTION SITE  
SHOWING SAND FILLED  
SURROUNDINGS**



## BAMBOO FINISHING OF SCHOOL WALLS AND CEILING





An aerial photograph showing a community with various houses and a large circular construction site. The site has a dark outer ring and a light-colored center. A dirt road runs through the community, and a body of water is visible on the right side with several boats. The surrounding area is lush with green trees and vegetation.

**AERIAL VIEW OF THE COMMUNITY  
AND ONGOING CONSTRUCTIONS OF  
SCHOOL AND STAFF QUARTERS**





**PROFILING AND REGISTRATION OF CHILDREN IN THE COMMUNITY FOR SCHOLARSHIP WHILE THE SCHOOL CONSTRUCTION WAS ONGOING.**





### COMMISSIONING OF THE SLUM2SCHOOL GREEN ACADEMY

(L-R) ANIA JUDSON (EDUCATION TEAM), ALHAJI MUKAILA HASSAN ELERU (COMMUNITY LEADER), MR OWOLABI FALANA (BOARD MEMBER, LAGOS STATE EDUCATION BOARD), ORONDAAM OTTO (EXECUTIVE DIRECTOR, SLUM2SCHOOL AFRICA), MRS ALERO AYIDA-OTOB (BOARD CHAIR, SLUM2SCHOOL AFRICA), HON. SIKIRU ADENIYI OWOLOMOSE (VICE CHAIRMAN EPE LGA), IYOBOSA OYAIDE (QUALITY AND REGULATORY AFFAIRS MANAGER, BIOMERIEUX)





**AERIAL VIEW OF THE SLUM2SCHOOL GREEN ACADEMY  
AT ~80% COMPLETION**



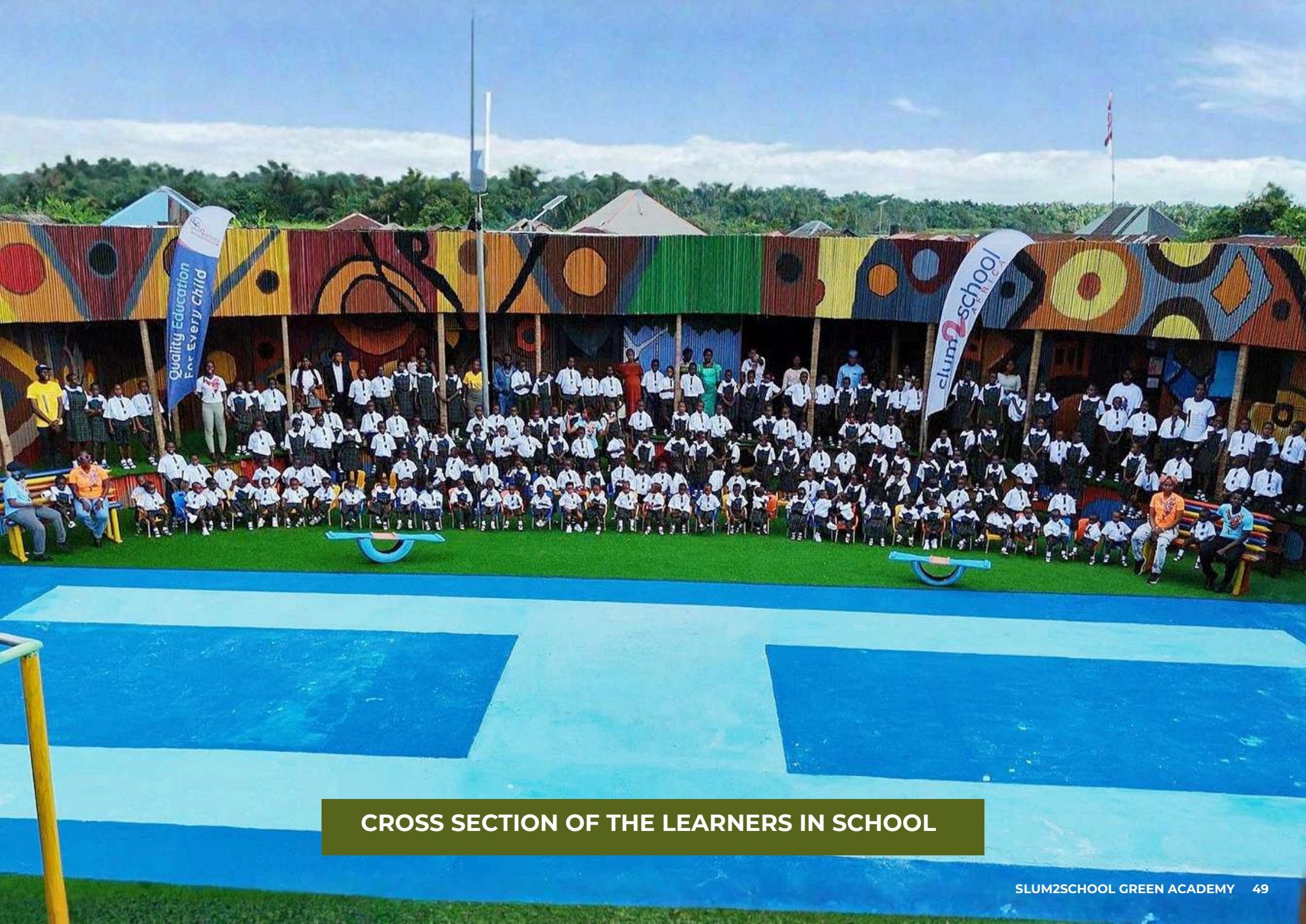

**CROSS SECTION OF THE LEARNERS IN SCHOOL**





### **BAMBOO ARCHITECTURE AND AFRICAN INSPIRED MOTIF**

**Built with sustainable bamboo, the Green Academy reflects strength, flexibility, and environmental responsibility suited to Saga's lagoon climate. Inspired by the Ubuntu philosophy - "I am because we are" - its circular design promotes communal learning and unity. The 54 interwoven shapes and colors in its motif celebrate Africa's diversity, symbolizing connection, culture, and shared purpose. Together, these elements make the Academy a model of sustainability, cultural pride, and collective progress in education.**





### ENERGY EFFICIENCY

The entire academy runs on solar energy - 90 solar panels of 300 watts each, a 6 KVA solar inverter, supported with 15kva lithium batteries - marking the first time Saga community has access to consistent electricity. This renewable system powers classrooms, computers, lighting, and water facilities, ensuring uninterrupted learning and safety.





### **BIOGAS SYSTEMS**

**The academy integrates biogas digesters that convert organic and toilet waste into clean cooking energy, promoting hygiene and environmental safety.**





### **WATER HYACINTH WEAVING AND COMMUNITY EMPOWERMENT**

**Local women were trained to convert invasive water hyacinths from the river into beautiful raffia used to wrap wooden pillars, line floors, and craft baskets. This initiative transformed an environmental challenge into an opportunity for skill development, economic empowerment, and sustainable artistry within the Saga community.**



## RAINWATER HARVESTING & BOLEHOLE

Provide reliable sources of clean water for drinking and sanitation - a solar-powered reverse osmosis system to further purify the borehole water - eliminating dependence on unsafe lagoon water and reducing water scarcity.







### **STAFF QUARTERS**

**To ensure continuity, safety, and commitment to quality education, the Green Academy includes four fully furnished staff quarters designed to accommodate teachers and support staff within the Saga community. These eco-friendly residences provide comfort, security, and proximity to the school, enabling educators to immerse themselves in community life and reduce the daily travel challenges common in coastal settlements.**





**TECHNOLOGY-ENABLED AND VIRTUAL LEARNING EXPERIENCE**  
The Green Academy integrates technology at the heart of learning, bridging the digital divide for children in Saga and neighboring communities. Through solar-powered smart classrooms, computers, and satellite internet connectivity, learners now access interactive lessons, virtual field trips, and global classrooms in real time.



**AERIAL VIEW OF THE SCHOOL BUILDING AT NIGHT**  
**10 solar powered surveillance flood light**







### **OUTDOOR CLASSROOM**

**Open, shaded space built from bamboo and natural materials. These areas promote experiential learning and play, blending academic lessons with environmental education and cultural activities.**





**NATURAL LIGHT & CLASSROOM VENTILATION**  
The open-plan classrooms maximize natural light and cross-ventilation, reducing the need for artificial cooling while creating vibrant, airy spaces for young learners.



## PLAY ARENA

The Green Academy's Play Arena promotes holistic child development through eco-friendly play, teamwork, creativity, and safe, inclusive spaces blending fun, learning, and growth.







# THE GREEN ACADEMY MODEL

The Green Academy represents a reimagined approach to education, one that blends learning, environment, and innovation to nurture not just students but a sustainable community. At its core, the model integrates early childhood education with climate-conscious infrastructure and digital inclusion, ensuring that children in underserved communities learn in safe, inspiring, and future-ready spaces.

Each element of the Academy is designed to teach by example. The bamboo classrooms, solar power systems, biogas digesters, and water-harvesting facilities are not just structures, they are daily lessons in sustainability. Learners grow up understanding renewable energy, waste recycling, and environmental stewardship as part of everyday life.

The curriculum extends beyond academics to include health, nutrition, psychosocial support, and digital literacy, ensuring children develop holistically, intellectually, emotionally, and socially. Teachers, trained and housed within the community, embody the academy's ethos of care and consistency.

In every sense, the Green Academy is a living classroom, where education meets ecology, innovation fuels inclusion, and learning transforms lives and landscapes.



# EDUCATION CURRICULUM AND SEVEN PILLARS

The Green Academy's learning framework is anchored on Slum2School's Accelerated Learning Model, an inclusive and adaptive curriculum designed to help children, especially those previously out of school, catch up academically, socially, and emotionally within a supportive learning environment. The model combines formal education standards with experiential, community-driven learning approaches that nurture each child's potential.

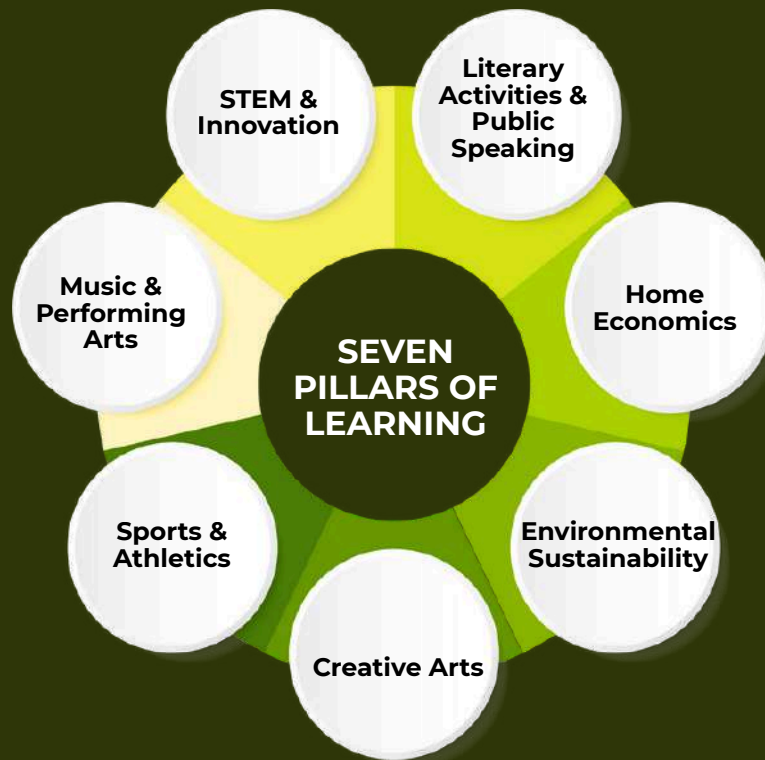

Together, these seven pillars create a dynamic ecosystem of learning — one that nurtures intellectual growth, emotional intelligence, creativity, and social responsibility. The curriculum's strength lies in its ability to accelerate learning while shaping well-rounded, future-ready children who can thrive in an ever-changing world.





# DIGITAL AND TECHNOLOGICAL INTEGRATION



At the heart of the Green Academy is a commitment to preparing learners for the future through digital inclusion and technological innovation. The school features smart classrooms, a computer lab, and reliable satellite internet connectivity, bringing global learning resources to a once-disconnected community. For the first time, children in Saga can explore the world beyond their lagoon, engaging in interactive lessons, digital storytelling, and virtual exchanges with peers and mentors across the globe.

Through the support of partners like HP and other technology collaborators, the Academy is equipped with modern learning tools that foster creativity, problem-solving, and digital literacy from an early age. Teachers receive continuous training to effectively integrate technology into classroom instruction, ensuring that every child, regardless of background, can thrive in a connected world.

This integration of education and technology bridges the digital divide, empowering learners to not only consume information but also to create, innovate, and lead in a rapidly evolving global society.



# SLUM 2 SCHOOL GREEN ACADEMY - INNOVATIVE AFFORDABLE SCHOOL



**CAPACITY TO SERVE 250 - 500 STUDENT PER COMMUNITY**





**CROSS SECTION OF SOME STAKEHOLDERS, PARTNERS, AND VOLUNTEERS WHO ATTENDED THE SCHOOL LAUNCH**





Share

## Join the incredible team working together to open the doors of the Slum2School Academy to 250 children in Saga community

Your impact

\$7,401.94 raised of \$31,550.00 goal



Give the gift of education to 250 children in Saga community.

For these children, education brings the freedom to live, dream big, education means hope. It is the key to breaking the cycle of poverty, uplifting entire families and unlocking a world of opportunities, and it is such a beautiful opportunity to be part of their life changing story.

When you give you get us closer to completing the school construction and full setup for learning to start. From January to February, every donation is going directly to help us reach this incredible milestone.

FUNDRAISING CAMPAIGN DRIVEN BY SLUM2SCHOOL VOLUNTEERS TO SUPPORT THE SCHOOL CONSTRUCTION AND LEARNING NEEDS.

Give once

Monthly

\$50

\$100

\$150

\$300

\$600

\$1,000

\$ 150

USD

☐ Dedicate this donation

Designate to children in Africa who need it most

[Add comment](#)

[DONATE](#)

[Is this donation secure?](#) [Is this donation tax-deductible?](#)

[Cancel my recurring donation?](#)

[Click Donate](#)  
[to support](#)  
[children in need](#)  
[and let their](#)  
[stars shine](#)





**Juliet, a 4-year-old girl from Saga Community, waves a Slum2School face cap in excitement during a visit by Slum2School team.**



**Juliet, after being enrolled into cluster learning, shaking hands with a Biomerieux Staff during a visit to the community**

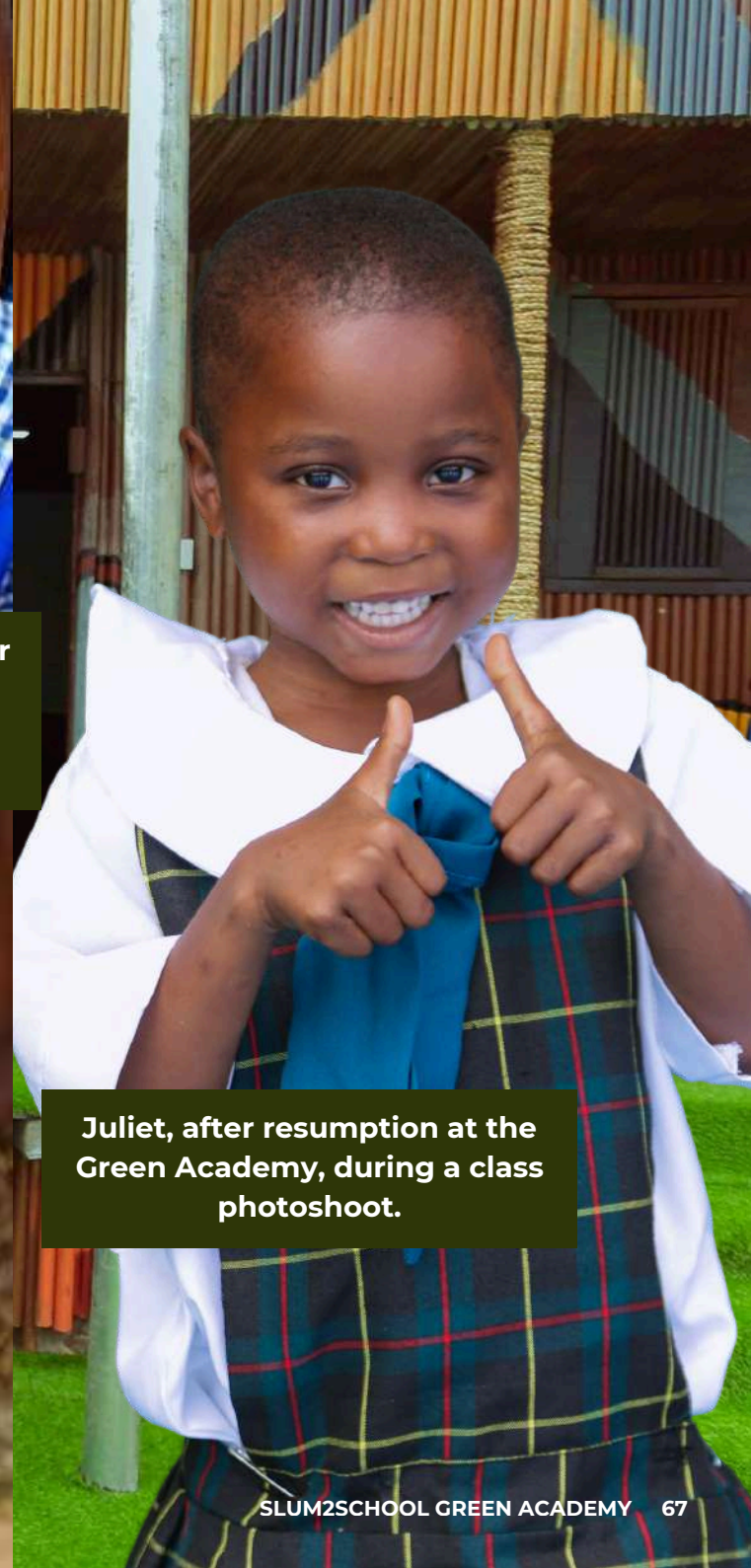

**Juliet, after resumption at the Green Academy, during a class photoshoot.**





# IMPACT AND OUTCOMES





# ENROLLMENT AND ACCESS TO EDUCATION

Since its commissioning, the Green Academy has opened its doors to 210 children from Saga and seven neighboring communities, marking a historic leap in access to early childhood education. Before the academy's establishment, no formal school existed within these communities, leaving over 80% of children of school age out of the education system.

The enrollment data reflects a growing culture of inclusion and equity, with 57% boys and 43% girls, ensuring balanced participation and bridging gender disparities in education. Daily attendance rates now average over 97%, a remarkable contrast to the inconsistent attendance patterns previously recorded among children traveling long distances by canoe to schools outside the community.

The presence of trained teachers, safe classrooms, school meals, and holistic child support services has significantly improved learning retention and community trust in formal education. Parents who once doubted the feasibility of schooling for their children now actively participate in school activities, reinforcing the belief that education can indeed thrive within their own community.

The Green Academy has not only expanded educational access but has also transformed community attitudes, turning education from a distant dream into a shared, living reality for every child in Saga.







**SOME LEARNERS AT THE SLUM2SCHOOL GREEN ACADEMY  
POSE FOR PICTURES DURING THE RESUMPTION PHOTO SESSION.**



# TEACHER DEVELOPMENT AND CAPACITY BUILDING

The success of the Slum2School Green Academy rests on the strength and commitment of its educators. From the outset, the project prioritized teacher recruitment, training, and continuous capacity development to ensure quality learning outcomes and long-term sustainability.

Qualified teachers were carefully selected based on their passion for early childhood education and willingness to integrate into the Saga community. To support their transition, staff quarters were provided within the school premises, ensuring stability, safety, and a deeper connection with learners and families.

Through partnerships with education experts and volunteer trainers, teachers undergo ongoing professional development covering child-centered pedagogy, inclusive education, digital literacy, psychosocial support, and environmental sustainability. A structured mentorship and peer-learning system enables teachers to exchange knowledge, strengthen classroom practices, and remain aligned with the Academy's holistic learning philosophy.



**CURRICULUM TEAM ENGAGING TEACHERS BEFORE THE COMMENCEMENT OF FORMAL SCHOOL LEARNING**

By investing in teachers as changemakers, the Green Academy builds not only classrooms of knowledge but also a community of inspired educators dedicated to nurturing the next generation of leaders.



# PSYCHOSOCIAL AND HEALTH SUPPORT SYSTEMS



At the Green Academy, education goes beyond academics, it embraces the total well-being of every child. Recognizing the deep social and emotional challenges faced by children in underserved communities, the school integrates psychosocial support as core components of its learning ecosystem.

Trained teachers provide regular mentorship sessions and emotional counseling, ensuring that learners feel safe, valued, and heard. Parents are counseled to give daily nutritious meals to their wards. This guarantees growth and concentration, addressing one of the major barriers to consistent learning in the community.

We also organize periodic medical checkups, and health education sessions are conducted in partnership with local health professionals and volunteers, promoting hygiene, disease prevention, and healthy living habits. Beyond the school, these interventions extend to families, strengthening overall community well-being and resilience.

By nurturing both mind and body, the Green Academy creates a compassionate environment where children can heal, grow, and thrive, turning education into a pathway not only to knowledge but also to holistic transformation.



# COMMUNITY EMPOWERMENT AND ECONOMIC IMPACT



The Green Academy was not only built for the Saga community, it was built with them. From inception, the project prioritized local participation, skills transfer, and economic inclusion, ensuring that the benefits of education extended beyond the classroom.

During construction, over 100 local artisans, laborers, and youth volunteers were engaged, gaining hands-on experience in bamboo architecture, solar installation, plumbing, and eco-construction techniques. This not only created immediate employment but also built technical capacity within the community, empowering individuals with lifelong skills.

Local suppliers provided materials and services, while families participated in school preparation activities, from landscaping to school setup, fostering pride and ownership. The introduction of the school also generated new livelihood opportunities for food vendors, transport operators, and small businesses, strengthening the local economy.

By embedding community empowerment into every stage of implementation, the Green Academy has become more than an educational institution — it is a catalyst for economic growth, dignity, and self-reliance across Saga and its neighboring communities.



**Women of Saga community present two fishes in appreciation to Slum2School and Biomerieux teams during a community visit, expressing gratitude for the positive impact on their community.**





# VOLUNTEERISM AND GLOBAL ENGAGEMENT



At the heart of the Green Academy's success lies the power of volunteerism - a movement of change makers united by compassion, purpose, and a shared belief in change. Over 1,000 volunteers from Nigeria and around the world devoted their time, skills, and resources to bring this vision to life. From architects and educators to engineers, artists, and health professionals, each volunteer played a vital role in shaping the Academy's journey from concept to completion.

Their efforts spanned community engagement, construction logistics, teacher training, digital learning, and psychosocial support - enriching the project with diverse expertise that bridged global knowledge and local realities. Strategic collaborations with corporate teams and international organizations further amplified the Academy's reach, proving how collective action can transform marginalized spaces into thriving centers of opportunity.

Through this spirit of service and collaboration, the Green Academy has become more than a school - it stands as a living testament to what humanity can achieve when people everywhere choose to give their time, talent, and hearts to a shared cause.



# PARTNERSHIP SHOWCASE - OTHER ALLIED SPONSORS



Norwegian Embassy



UNIVERSAL MUSIC GROUP



The Slum2School Green Academy's success was powered by visionary partnerships that strengthened every aspect of the project. bioMérieux provided the launchpad, serving as the principal funder that brought the Academy's vision to life. Afritech enhanced teaching quality through capacity development, UMG supported learner scholarships, and the Norwegian Government established early childhood maker spaces. TritonICL added color and vibrance with eco-friendly paints, Preserve Our Roots created the outdoor play arena, HP equipped the digital classrooms, United Airlines provided school backpacks for learners and through collaborative support from the Epe Local Government, Lagos State Education Board, we forged partnership with the government to ensure sustainability.

Together, these partners embody the power of collaboration - uniting diverse sectors to build a sustainable, inclusive, and innovative model for education in underserved communities.



# STORIES OF CHANGE AND TESTIMONIALS



This creativity and innovation of the Slum2School Green Academy is world-class and can only be made possible when vision meets commitment. I am very proud of the entire team and certain that this will be first of many more to be built across Africa.

**Mrs. Alero Ayida-Otobo, Board Chairperson, Slum2School Africa**

This project has restored hope to our children and renewed parents' confidence in accessing quality education within the community. It will leave a lasting impact on generations to come. We assure you the school will be maintained and used for its intended purpose.

**Hon. Sikiru Adeniyi Owolomose, Vice Chairman of Epe LGA**



When we first distributed learning materials while the school was still under construction, we were inspired by the vision and the community's spirit. To now see the Green Academy standing tall, filled with children eager to learn, is truly remarkable.

**Victor Ozotha, Key Account Manager, United Airline**



We wanted education for our children, but it never came. We thought maybe it was not meant for us. We thought we would never see this day. Now, for the first time, our children will learn here at home.

**Mr Emiloju, Community Elder**



This model shows what is possible when government and innovative organizations work together. What Slum2School Africa has done is an act of equity in action, and with government collaboration, it is a model ready to be replicated.

**Hon. Owolabi Falana, Lagos State SUBEB**





# STORIES OF CHANGE AND TESTIMONIALS CONT.



The Slum2School Green Academy sets a new benchmark for early childhood education in Nigeria. It aligns with our vision for teacher professionalism and quality learning. This school demonstrates how innovation and dedication can transform the educational landscape.

**Oluwabusola Aro, Teachers Registration Council of Nigeria (TRCN) Lagos State Coordinator**



Before this school, our children had to travel by boat and trek for about 45 minutes to learn, and many could not go at all. Today, we have a safe, beautiful place right here in our community. As a mother and woman leader, I am grateful, this school gives our children hope and a future.

**Ereme Uyakumoh, Women Leader, Saga community**



Leaving the mainland to live and teach here in Saga has been one of the most rewarding decisions of my life. Every day, I see children who once had no access to learning now counting and dreaming big.

**Mary Sunnuvun, Slum2School Green Academy Teacher**



These children come to school eager to learn, and knowing that I can help shape their future is the most rewarding part of my work. Being part of the Green Academy reminds me that education truly changes lives - one child at a time.

**Michelle Ijeojealero, Slum2School Green Academy Teacher**



Every morning, I bring my children and a few others from our village across the water to this school. Our school back home does not have teachers. This school has given our children a chance to learn and to dream. We even have life jackets for our children, now the boat rides feel safe.

**Gabriel Wilson, from Abomity Community**





**VISIBILITY, DATA & LEARNING**



# IN THE NEWS

BUSINESS  
INSIDER  
AFRICA





# IN THE NEWS



## Slum2School Green Academy: Redefining education and sustainability in Africa's underserved communities

BI AFRICA | 20 October 2025 12:29 PM



#FeaturedPost



Slum2School Green Academy, in Saga community, Epe, Lagos.  
Courtesy Slum2school Media

In the heart of Lagos, on the banks of the Saga community in Epe, stands a structure unlike any other in Nigeria: The Slum2School Green Academy. Built from bamboo, powered entirely by solar energy, harvesting and purifying rainwater, converting waste to biogas and equipped with cutting-edge digital tools, the academy is more than a school. It is a symbol of hope, resilience, and Africa's capacity to reimagine education for the future.

ADVERTISEMENT

## Slum2School Africa Builds Nigeria's First Fully Eco-Friendly Green School in Lagos, Nigeria.

PREMIUM | 1 month ago

On Saturday, September 13, 2025, a new chapter was written in the history of Nigeria, as Slum2School Africa, one of the continent's leading education nonprofits, commissioned the Slum2School Green Academy – a groundbreaking, fully eco-friendly school designed to bring learning, clean water, electricity, and connectivity to a community long



## Slum2School Africa launches Nigeria's fully eco- friendly Green Academy in Saga community, ending decades without school

By: 'Sola Akinsanmi Date: 13 Sep 2025

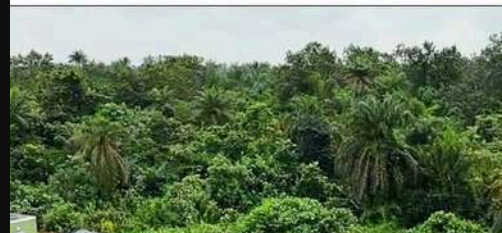

## A New School Rises in Lagos: Slum2School Africa Launches Nigeria's First Fully Eco- Friendly Green Academy

18 September 2025 at 17:51



Slum2School Africa is a volunteer-driven nonprofit committed to ending Africa's education crisis.





# IMPACT DATA AND KEY RESULTS

Since inception, the Green Academy has become a measurable model of progress and sustainability in Saga and its neighboring communities. Over 250 children have been enrolled, with an equal gender balance, marking a 97% increase in school attendance compared to pre-project figures. Through the academy's solar-powered systems, the community now enjoys 24/7 access to clean, renewable energy, eliminating the need for generators and reducing over 12 tons of CO<sub>2</sub> emissions annually.

Access to clean water through boreholes and rainwater harvesting now benefits over 800 residents, while the biogas system converts daily waste into energy, promoting hygiene and environmental stewardship. More than 50 jobs have been created during and after construction, and over 1,000 volunteers have contributed to the project's implementation and ongoing activities.

The impact data collectively show not just an educational transformation but a holistic community uplift, integrating learning, sustainability, and local empowerment for lasting change.

**250+**

**CHILDREN ENROLLED  
ACROSS SAGA AND 7  
NEIGHBORING COMMUNITIES**

**97%**

**INCREASE IN ATTENDANCE  
COMPARED TO PRE-PROJECT  
BASELINE**

**15**

**CLASSROOMS DELIVERING  
EARLY CHILDHOOD AND  
FOUNDATIONAL EDUCATION**

**100%**

**SOLAR-POWERED CAMPUS -  
FIRST IN THE COMMUNITY**

**1000+**

**VOLUNTEERS ENGAGED  
ACROSS COMMUNITIES**

**5,000+**

**COMMUNITY MEMBERS  
DIRECTLY IMPACTED.**



# MONITORING, EVALUATION, ACCOUNTABILITY & LEARNING (MEAL)



To ensure effective implementation and alignment with project objectives, the following indicators will be tracked regularly:

## **Student Enrollment and Learning Outcomes**

- Enrolment and attendance rates disaggregated by gender and age
- Assessment results tracking literacy and numeracy progress
- Retention rates and transition outcomes

## **Teacher Performance and Development**

- Attendance, punctuality, and lesson delivery quality
- Participation in training and continuous professional development
- Classroom management, child engagement, and use of innovative teaching methods
- Student learning outcomes in literacy, numeracy, and holistic skills

## **School Management and Administration**

- Effective coordination of academic and non-academic activities
- Implementation of school policies, safety standards, and schedules
- Engagement with parents, community, and local authorities
- Timely reporting, record-keeping, and data submission



# MONITORING, EVALUATION, ACCOUNTABILITY & LEARNING (MEAL) CONT.

## **Support Staff (Cleaners, Security, Caretakers)**

- Adherence to hygiene and sanitation standards
- Maintenance of school facilities and equipment
- Safety protocols and protection of school property
- Responsiveness to operational needs and emergencies

## **Learning Environment and Infrastructure**

- Functionality and maintenance of classrooms, solar systems, and water facilities
- Availability and condition of learning materials, furniture, and digital devices
- Cleanliness, safety, and child-friendly design of learning and play spaces

## **Community and Stakeholder Engagement**

- Level of community participation and ownership
- Feedback from parents and local leaders
- Volunteer involvement and partner collaboration





# RESEARCH & REPLICATION POTENTIAL

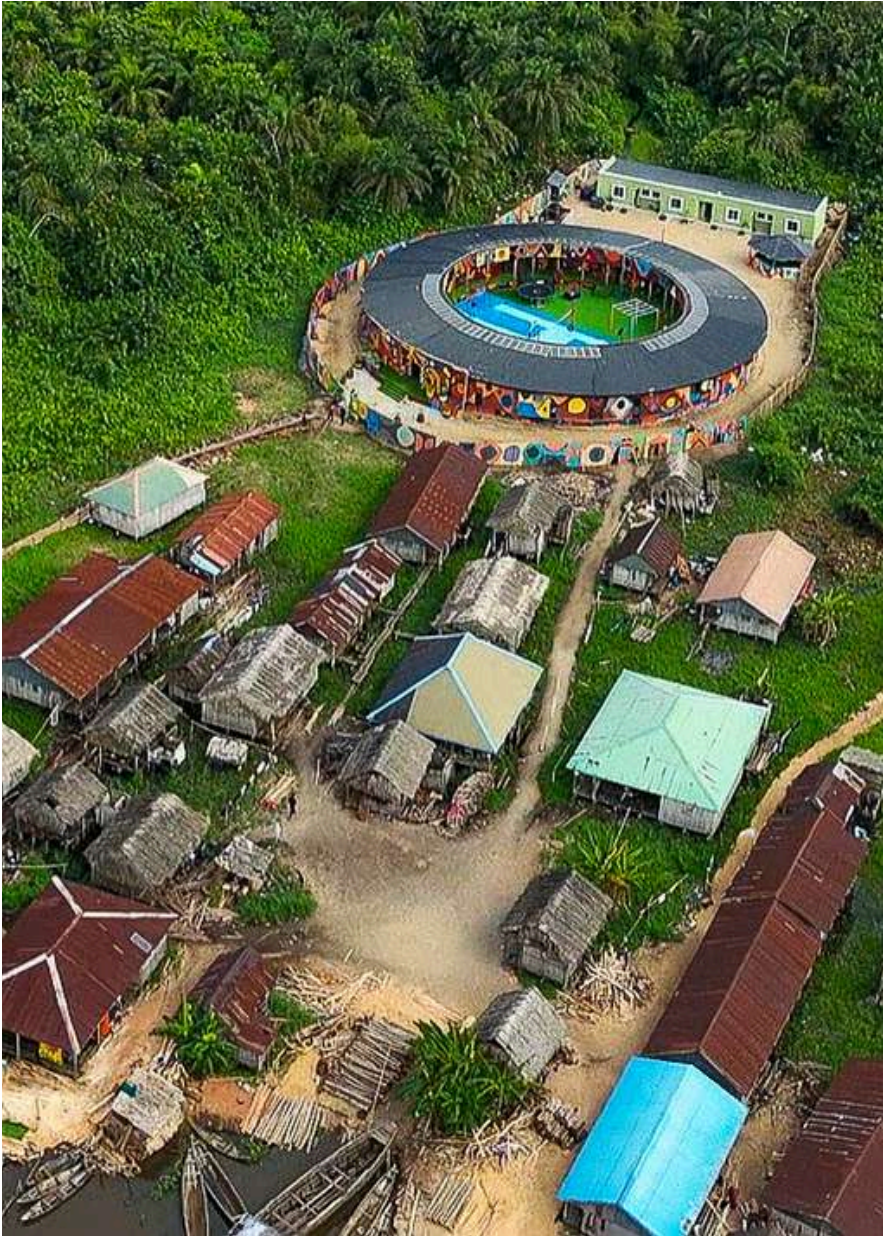

The Green Academy represents a scalable model that integrates education, sustainability, and community empowerment - a framework designed for replication across underserved communities in Nigeria and Africa. Its modular bamboo architecture, solar-powered systems, biogas energy, and water innovations are adaptable, cost-effective, and environmentally resilient, making the model both sustainable and replicable.

Replication is anchored on community engagement, local labor participation, and multi-sector partnerships to ensure ownership and long-term impact. The process begins with community needs assessments and participatory design workshops, followed by phased construction, teacher training, and system optimization. Each element - from classrooms and solar grids to water systems and digital connectivity - functions as a modular unit that can scale with available resources.

The model's strength lies in its integrated impact - combining education, health, energy, and environmental solutions for holistic development. Future replication will emphasize local governance, capacity building, and blended financing through donor support, CSR investments, and community contributions.

Ongoing research tracks learning outcomes, operational efficiency, and environmental benefits to guide adaptation across diverse settings, from coastal to rural communities. With strong documentation, policy alignment, and technical support, the Green Academy model stands as a practical blueprint for transforming learning spaces into sustainable community ecosystems across Africa.



# SAFEGUARDING AND CHILD PROTECTION

At Slum2School Africa, the safety and well-being of every child are non-negotiable priorities. Safeguarding goes beyond policy - it is a culture deeply rooted in every program, partnership, and practice. At the Slum2School Green Academy, this commitment is brought to life through a comprehensive Child Protection and Safeguarding Plan that aligns with both global and national standards, ensuring every learner is protected from harm, abuse, neglect, and exploitation.

Our goal is to create a nurturing and empowering environment where children feel valued, respected, and free to speak up without fear. Through proactive prevention, continuous staff training, and community collaboration, we ensure that protection is not just reactive but built into the very foundation of our systems.

The Slum2School Green Academy's Safeguarding Framework is anchored on the following key pillars:

- **Clear Policy Framework:** Guided by the UNCRC and Nigerian Child Rights laws.
- **Mandatory Training:** Regular safeguarding and ethical conduct sessions and examinations for all staff, teachers, and volunteers.
- **Safe Recruitment:** Strict vetting, background checks, and references before engagement.
- **Child-Centered Reporting:** Confidential, accessible systems for reporting and response.
- **Psychosocial and Health Support:** On-site counselors promoting mental and emotional well-being.
- **Safe Spaces and Supervision:** Gender-sensitive, well-supervised facilities for all learners.
- **Accountability and Collaboration:** Strong partnerships with local stakeholders, ensuring transparency and adherence to global standards.

Together, these principles safeguard every child's right to safety, dignity, and holistic growth.







**CHALLENGES, FINANCES & FUTURE**



# CHALLENGES AND MITIGATION STRATEGIES



Like many transformative projects in challenging terrains, the Green Academy's journey faced uncontrollable obstacles. A major setback was the overgrowth of water hyacinth - an invasive aquatic weed that spread across Lagos waterways for over seven weeks. This disruption halted boat movement, delayed material delivery to Saga, and extended timelines. Despite these challenges, the team adapted swiftly, revising schedules and pushing forward with resilience and commitment to the vision.

Adding to these hurdles were severe macroeconomic shocks that disrupted the national economy during implementation. The Naira's steep depreciation from ₦508 to ₦1,780 per Euro and the surge in petrol prices from ₦238 to ₦1,100 per liter fueled inflation across all project components. Prices of key materials like hardwood, roofing sheets, power equipments and other essentials rose by over 120% - 280%, straining procurement and financial planning.

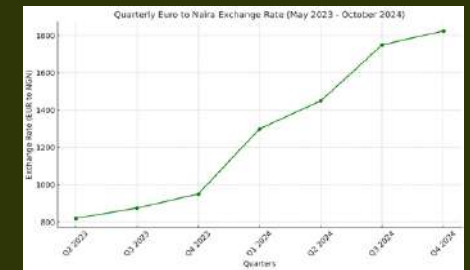

In addition, manual sand excavation from the river presented a major logistical hurdle. Automatic dredging, initially proposed, became unfeasible as its cost soared by over 400% beyond the original budget. The project team swiftly adapted, mobilizing community members and deploying more than 220 30tons of locally operated boats for phased landfilling. Together, they successfully raised the 3000 sqm site by 2-3 feet, creating a safer play and learning environment even during high tidal seasons.

Despite these constraints, the project team demonstrated resilience and innovation, revising timelines, renegotiating supplier terms, leveraging community labor, and optimizing material use to maintain quality without compromising sustainability goals. Through collaborative problem-solving and adaptive financial management, the Slum2School Green Academy is successfully completed, standing today as a testament to perseverance and partnership under challenging conditions.



## WATERWAYS DURING AND AFTER THE OVERGROWTH OF WATER HYACINTH





# SUSTAINABILITY PLAN AND NEXT STEPS

The Green Academy was designed not only as a school but also as a sustainable ecosystem, a living model of education, innovation, and environmental consciousness. Its long-term sustainability rests on three key pillars: community ownership, operational efficiency, and strategic partnerships.

A local management committee comprising community leaders, teachers, and parents has been established to oversee maintenance, enrollment, and resource management. Continuous training and mentorship programs ensure that teachers and caretakers remain equipped to deliver quality education and sustain the academy's learning outcomes. Solar power, biogas systems, and rainwater harvesting reduce operational costs while reinforcing environmental stewardship.

Looking ahead, the focus is on scaling the Green Academy model to other underserved communities across Nigeria and Africa. The next phase will expand access to more children, strengthen digital learning infrastructure, and replicate the integrated systems of education, clean energy, water, and health demonstrated successfully in Saga.

The bioMérieux Endowment Fund's continued partnership will remain instrumental in this journey, supporting research, technical innovation, and the establishment of new learning centers modeled after the Green Academy. Together, we aim to transform more communities into hubs of opportunity, resilience, and sustainable growth, ensuring that every child, regardless of background, can learn and thrive in a safe, inspiring, and sustainable environment.

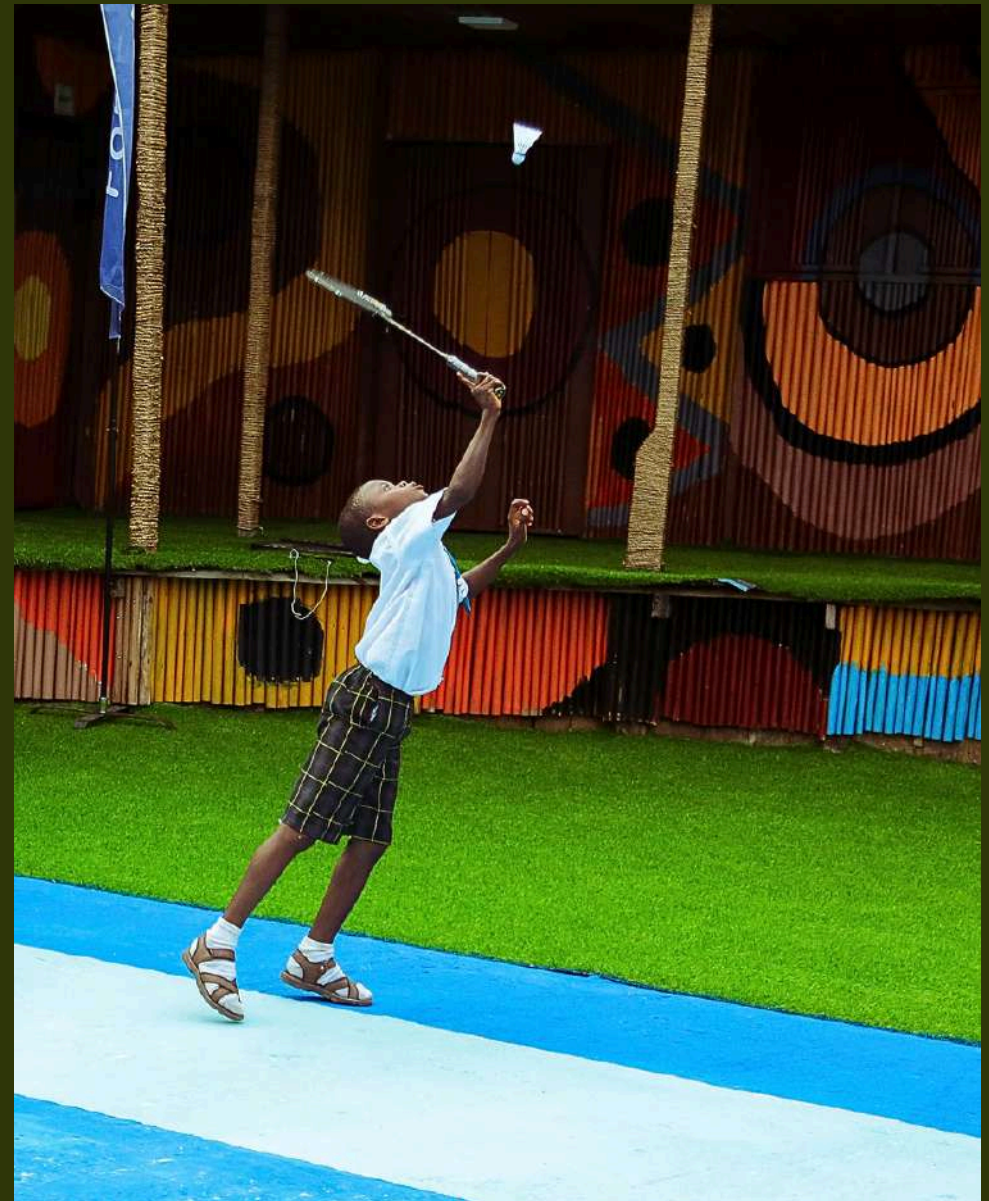



# FINANCIALS

The Slum2School Green Academy Project was developed under a three-year integrated financial framework (2024 - 2026) with an estimated total budget of USD 311,540 (€274,899.32), designed to ensure infrastructural durability, academic continuity, and institutional sustainability.

The budget architecture encompasses capital expenditure for construction and facility development, and operational expenditure for scholarships, teacher/staff salaries and welfare, instructional materials, administration, technology integration, community engagement, maintenance, and monitoring and evaluation systems.

Through a blended financing model comprising grants, philanthropic donations, in-kind contributions, and volunteer technical support, approximately 79% of total project costs have been actualized with one year remaining in the fiscal cycle.

Financial implementation follows a phased fundraising and partnership development strategy, integrated with liquidity forecasting, variance analysis, and donor compliance frameworks.

All fiscal operations are aligned with IFRS nonprofit reporting protocols, ensuring transparency, financial sustainability, and measurable return on social investment.

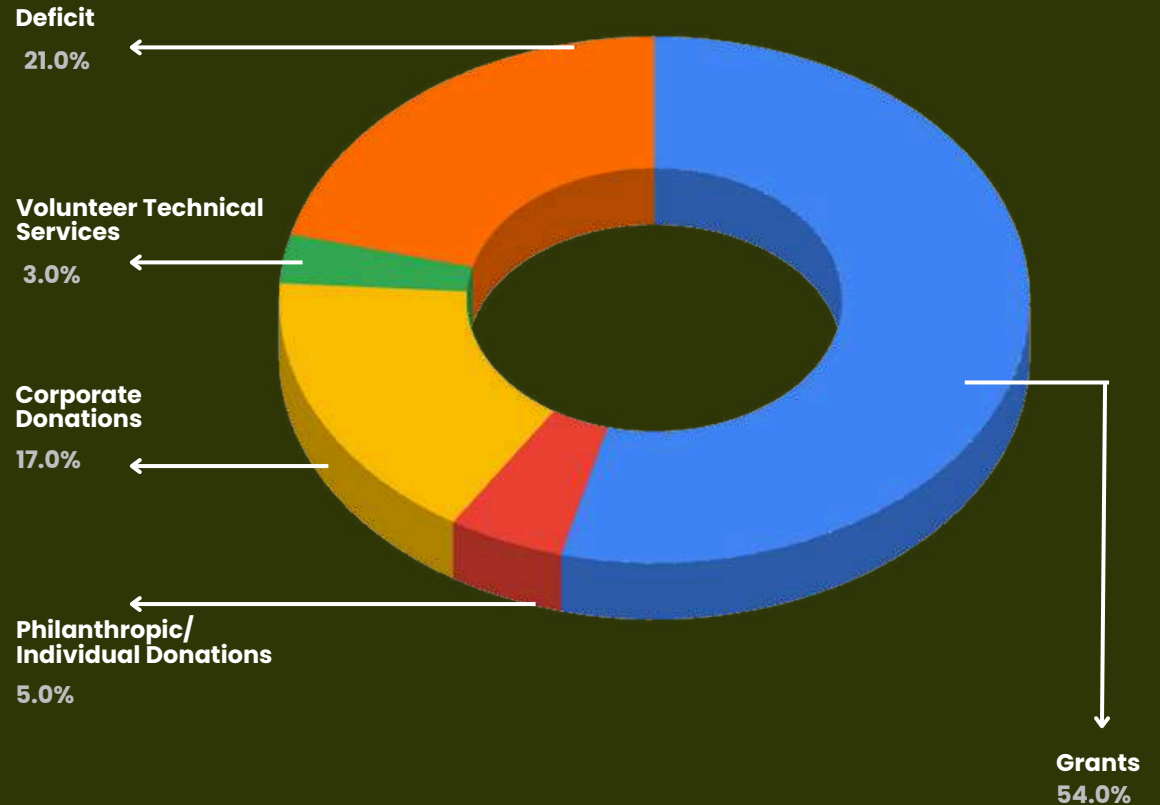

**Funding Source Breakdown and Deficit Allocation**



# FINANCIALS CONT.

From 2024 to 2026, the Green Academy's projected investments focus on what matters most: building, learning, and community. Most resources are directed toward construction and infrastructure, children's scholarships, and teacher welfare, while others support school management and community engagement. Thanks to partners like bioMérieux, HP, United Airlines, the Norwegian Embassy, Triton Paints, Afritech, Preserve Our Roots, and several other organizations, volunteers, and donors, each contribution, from technology and materials to funding and training, has strengthened the school's foundation. Looking ahead, projections for 2025–2026 emphasize maintaining the Academy, expanding scholarships, and replicating the model to reach more children across communities.

Project Cost Allocation by Key Program Areas

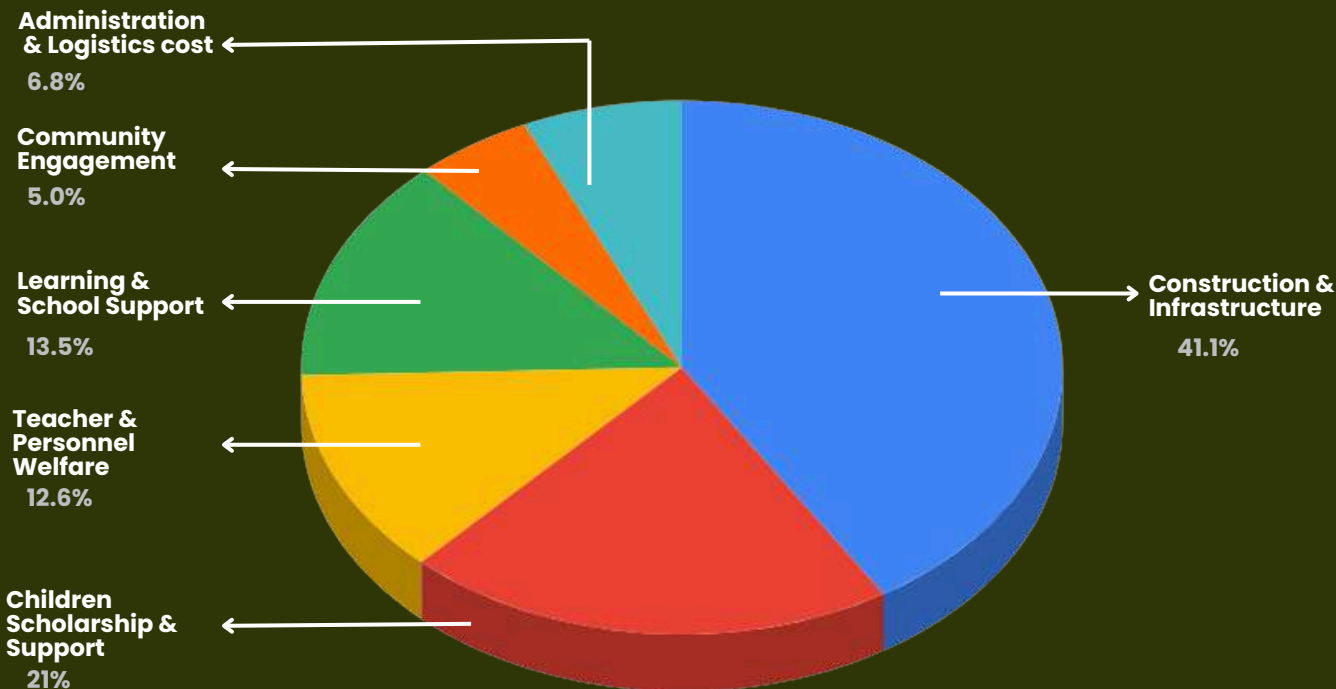

Annual Project Budget Projection \$ (2024–2026)





# FINANCIALS CONT.

EVERY ₦200,000 (\$150) YOU GIVE PROVIDES A CHILD WITH ONE FULL YEAR OF QUALITY EDUCATION - COVERING TUITION, SCHOOL SUPPLIES, MEDICAL CARE, TEACHER SALARIES, AND COMPREHENSIVE WRAPAROUND SUPPORT SERVICES.

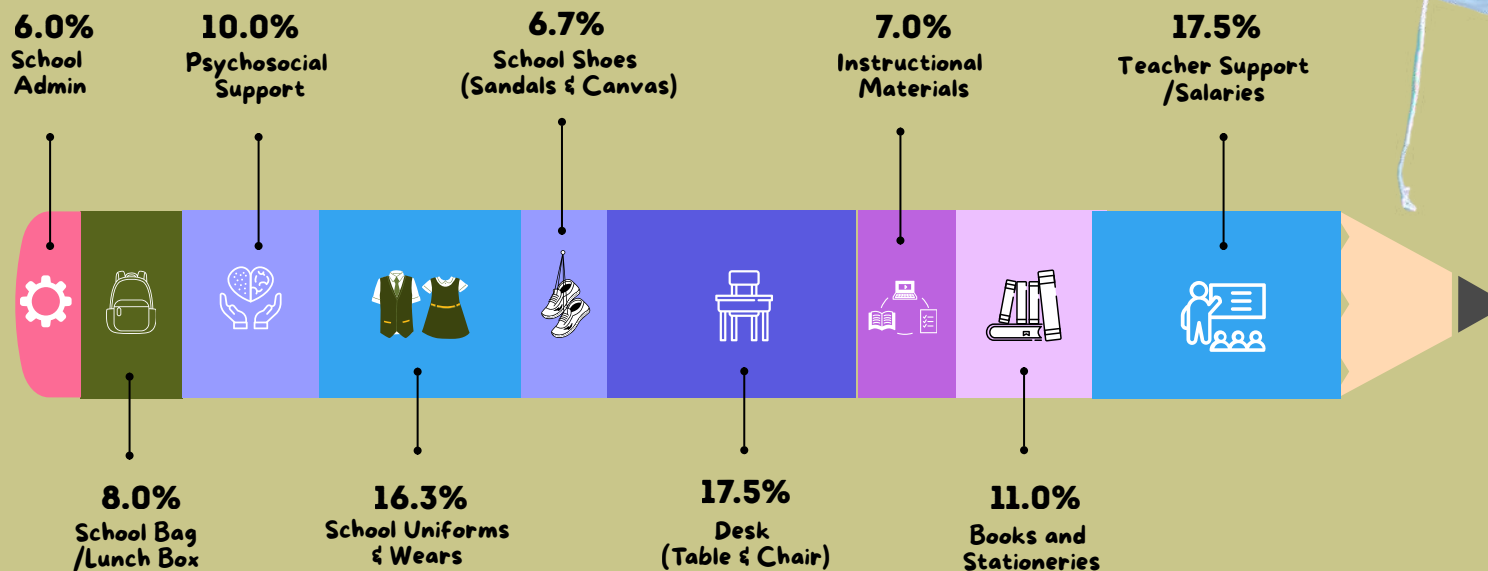

BAR CHART ILLUSTRATING PERCENTAGE DISTRIBUTION OF EACH SCHOLARSHIP SUPPORT PER CHILD.





# OUTSTANDING PROJECTS



As we continue to build a world-class, sustainable learning environment for hundreds of children, a few key projects remain outstanding. Completing these will help us strengthen safety, expand access, and enhance the quality of learning for every child at the Academy.

Here are some of the outstanding needs you can support to help us finish strong:

- Complete school landscaping and flooring, creating multiple play areas and safer walk paths.
- Solar powered school boat for children in neighbouring communities.
- Life jackets for water transportation.
- Smoke detector, alarm system, and water sprinklers
- Security alarm for teaching staff
- Security post and 2 guards
- Property Insurance
- Community to school walkway
- Skills and talent development center
- Additional solar power for community lighting.
- Sustainable scholarship support the learners.



# THE GREEN ACADEMY AND THE FUTURE

The Slum2School Green Academy has become more than a dream fulfilled - it has ignited a movement.

What began as hope for one community has now inspired organizations, governments, and changemakers to reimagine what education can be. From its bamboo walls to its solar rooftops, the water purification system and the biogas production systems, the Green Academy stands as proof that sustainable, inclusive learning is possible.

Today, it's not just a model - it's a blueprint for the future and hope for millions of children in need.

We are optimistic of this vision scaling across Africa, bringing light, learning, and lasting change to every child.

The future of education is here - and we thank you for being a part of the journey.

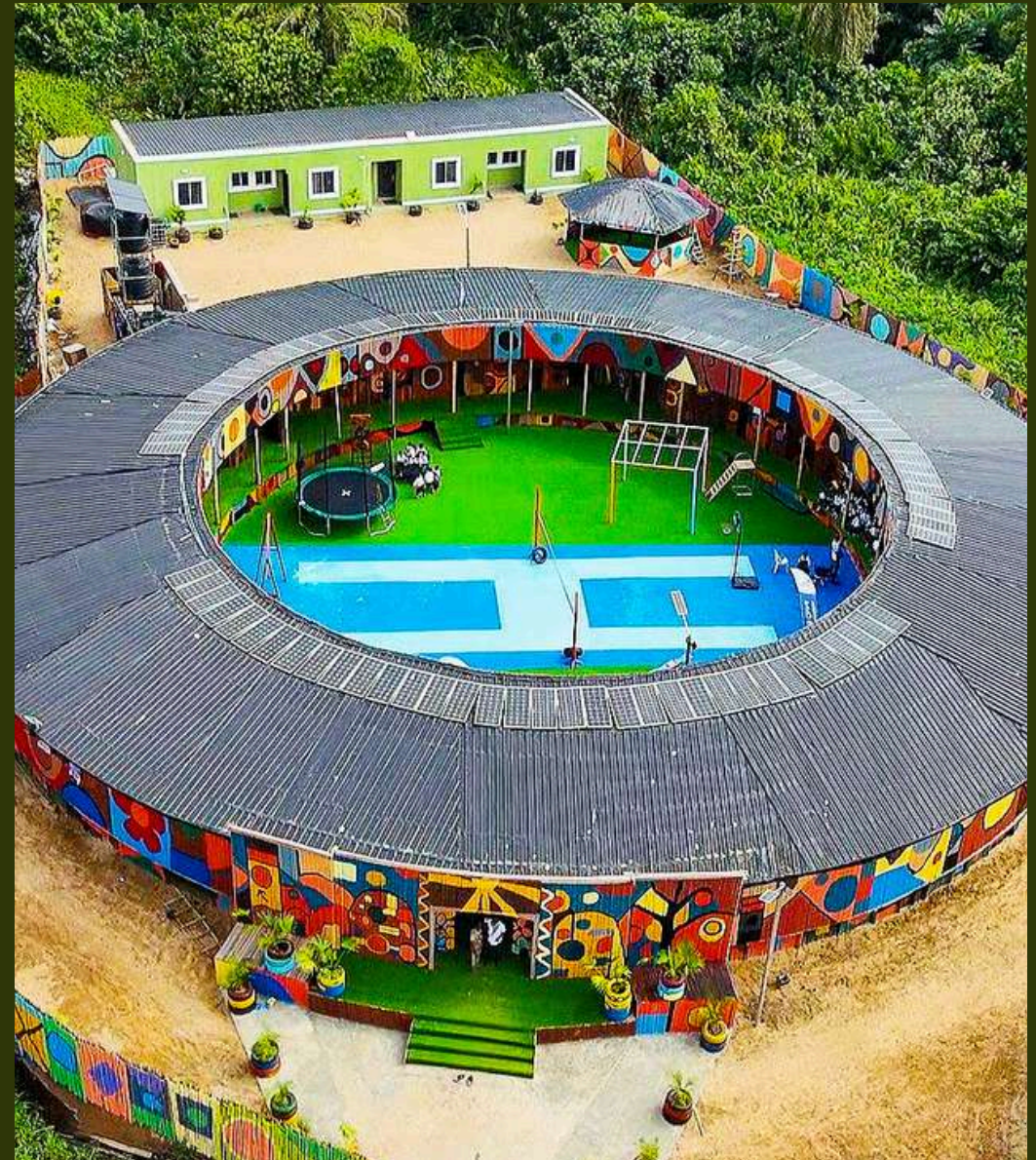





## APPRECIATION MESSAGE

As I look back on the journey that birthed the Slum2School Green Academy, my heart is filled with gratitude and awe. What began as a dream - a hope to give the children of Saga and its neighboring communities a chance to learn, to grow, and to believe in their own potential - has become a living reality.

This school was not built by hands alone, but by hearts united in purpose. To our incredible partners, especially the bioMérieux Endowment Fund, and every organization that believed in this vision, thank you for choosing to invest in hope. To our volunteers, who worked under the sun and through the rain, your strength and commitment brought this dream to life.

To the local and state government, particularly the Epe Local Government Chairperson, Princess Surah Olayemi Animashaun, community leaders, and parents who stood beside us every step of the way, this success is yours too. You gave us your trust, your land, and your people's support. To our teachers who left the comfort of the city to live among the community and nurture its children, you are heroes of this story. And to the children, the true reason we built this school, your laughter and light fill every corner of this academy with meaning.

Yet, our work is not complete. The Green Academy is a foundation, one that will continue to grow with every hand that joins ours. There are still classrooms to equip, programs to expand, and dreams to sustain. I invite you, our friends, partners, and supporters, to keep walking with us. Together, we can ensure that the light of learning that now shines in Saga spreads to many more communities across Africa.

Warm regards,

**Adekunle Idowu**

Snr. Project Manager  
Slum2School Africa



**BEFORE MEETS AFTER - ONE YEAR APART  
PROJECT TEAM DURING AND AFTER CONSTRUCTION**

**OCTOBER 2024**



**OCTOBER 2025**





# CONTACT US AND GET INVOLVED



**AFRICA HQ.**  
**Slum2School Innovation Hub,**  
13, Babatope Bejide Crescent,  
Lekki 1,  
Lagos, Nigeria

✉ [info@slum2school.org](mailto:info@slum2school.org)

☎ +234 (0) 814 2828 750

🌐 [www.slum2school.org](http://www.slum2school.org)

